

SS2018 ANNUAL
CANCER
SYMPOSIUM

March 21-24 | Chicago, IL

THE EXCEPTIONAL SURGICAL ONCOLOGY EXPERIENCE

THE
SPECTRUM OF INNOVATION
AND APPLICATION

SEE INSIDE FOR OUR
SCHEDULE-AT-A-GLANCE!

#SSO2018 | SSO2018.ORG

SSO Society of
Surgical Oncology®

EXPLORE



AT THE SSO
MEMBERSHIP
BOOTH 616.

Concurrent Sessions, Quick Shot Abstracts,
The Great Debates – Can't Attend Everything?

**ExpertEd@SSO Delivers the
SSO 2018 Virtual Meeting**

ExpertEd@SSO is the post-SSO 2018 resource to view missed sessions and hear notable speakers a second time. Convenient to access and easy to navigate, ExpertEd@SSO records participation in virtual meeting sessions and programs for easy future reference.

In addition to the SSO 2018 Virtual Meeting, ExpertEd@SSO also offers a variety of webinars and *Annals of Surgical Oncology* journal CME activities on solid-tumor topics. These educational programs are **free to members** and CME and MOC credits are automatically transferred to the American Board of Surgery.

Visit ExpertEd@SSO at surgonc.org/ExpertEd to review the product catalog, attend a Virtual Meeting session or enroll in an educational program.

SSO Society of
Surgical Oncology®

SCHEDULE-AT-A-GLANCE

As of 2/14/18

All Sessions are in the McCormick Place
Convention Center unless stated otherwise.

KEY:		Addresses, Lectures and Awards	
	Breast		* Abstract Sessions
	Colorectal		Δ Separate Registration Required
	Gastrointestinal (HPB/Pancreas)		
	General Education		
	Sarcoma		
	Melanoma		
	Other Surgical Oncology		
	Exhibit Hall Events and/ or Breaks		

THURSDAY, MARCH 22	FRIDAY, MARCH 23	4-6 pm Melanoma Parallel Session* • Room E350
6:45-7:45 am Industry Forum (Genentech) Room E353c	Welcome Reception; View Exhibits/Posters*/Fellows & Resident's Lounge • Exhibit Hall 4D1	SATURDAY, MARCH 24
8-9:30 am Novel Clinical Trials in Breast Cancer Room E450a	6:45-7:45 am Meet the Professor Breakfasts Δ	6:45-7:45 am Meet the Professor Breakfasts Δ
8-9:30 am Contemporary Management of Thyroid Cancer (MOC) • Room E450b	7-8 am Poster Contest Grand Rounds* • Exhibit Hall D1 Foyer	8-9:30 am Local & Regional Therapy Options for Primary and Metastatic Tumors in Hepatobiliary Surgery (MOC) Room E450a
8-9:30 am Managing the Future Liver Remnant Room E451b	8-8:45 am • Plenary I* • Room E354b	8-9:30 am My Patient Read the Internet: Molecular Markers and Novel Treatments for Colorectal Cancer (MOC) Room E450b
8-9:30 am Case Presentations with Fellows & Professors Room E350	8:45-9 am The Charles M. Balch, MD, Distinguished Service Award & James Ewing Layperson's Award Room E354b	8-9:30 am Subtype-Specific Biology and Treatment of Soft Tissue Sarcomas (MOC) • Room E451b
9:30-10:15 am Exhibit Hall Opening Refreshment Break, Thursday Exhibit Hall Videos, View Exhibits/Posters/Lounge Exhibit Hall D1	9-9:45 am • SSO Presidential Address • Room E354b	8-9:30 am Disparities Parallel Session* Room E350
9:30 am-7:30 pm Thursday Posters • Exhibit Hall D1	9:45-10:15 am Refreshment Break, Friday Exhibit Hall Videos, View Exhibits/Posters/Lounge • Exhibit Hall D1	9:30-9:45 am • Refreshment Break • Hall D1 Foyer
10:15 am-12:15 pm Breast Parallel Session I* • Room E450a	9:45 am-4 pm Friday Posters • Exhibit Hall D1	9:45-10:30 am American Cancer Society/SSO Basic Science Lecture Room E450b
10:15 am-12:15 pm Quality Improvement/Clinical Outcomes Parallel Session* • Room E450b	10:15 am-12:15 pm Breast Parallel Session 2* • Room E450a	10:30-11:05 am Clinical and Young Investigator Award Presentations Room E450b
10:15 am-12:15 pm Robotic Assisted Minimally Invasive Surgical Oncology (MOC) • Room E451b	10:15 am-12:15 pm Hepato-pancreato-biliary Parallel Session 2* Room E450b	11:05 am-12:30 pm The Great Debates II • E450b
10:15 am-12:15 pm The Future of Surgical Oncology Reimbursement in the Era of Bundled Payments • Room E350	10:15 am-12:15 pm Adaptation of New Technology for Rectal Cancer: Do I Need New Tools in My Toolbox? (MOC) Room E451b	11:15 am-12:15 pm HPB and Upper GI Quick Shot Abstracts • E450a
12:15-1:15 pm Exhibit Hall Opening Lunch; View Exhibits/Posters/ Fellows & Resident's Lounge; Poster Grand Rounds* and Amgen Exhibit Hall Theater Presentation Exhibit Hall D1	10:15 am-12:15 pm Current Management of Nodal Metastases in Patients with Melanoma (MOC) • Room E350	11:15 am-12:15 pm Sarcoma Quick Shot Abstracts • Room E451b
1:15-1:30 pm Welcome and Announcements • Room E354b	12:15-1:15 pm Exhibit Hall Lunch; View Exhibits/Posters/Fellows & Resident's Lounge; Poster Grand Rounds* Exhibit Hall D1	12:30-1:30 pm • Lunch on Own
1:30-2:15 pm James Ewing Lecture • Room E354b	1:15-2 pm • Plenary II* • Room E354b	1:30-3 pm Upper Gastrointestinal Parallel Session* • Room E450a
2:15-3 pm John Wayne Clinical Research Lecture • Room E354b	2-3:15 pm • The Great Debates I • Room E354b	1:30-3 pm Top Rated Videos* • Room E450b
3-4 pm Refreshment Break, View Exhibits/Posters/Fellows & Resident's Lounge; Poster Grand Rounds* Exhibit Hall D1	2:15-3:15 pm Breast Quick Shot Abstracts • Room E450a	1:30-3 pm Sarcoma Parallel Session* • Room E451b
4-6 pm Controversial Topics in Breast Surgical Management to Improve Outcomes (MOC) • Room E450a	2:15-3:15 pm Quality/Outcomes Quick Shot Abstracts • Room E450b	3-3:15 pm • Refreshment Break • Hall D1 Foyer
4-6 pm Endocrine Parallel Session* • Room E450b	2:15-3:15 pm Colorectal Quick Shot Abstracts • Room E451b	3:15-4:45 pm Surgical Cyoreduction and Regional Chemotherapy: State of the Science • Room E450a
4-6 pm Hepato-pancreato-biliary Parallel Session 1* Room E451b	2:15-3:15 pm Melanoma Quick Shot Abstracts • Room E350	3:15-4:45 pm Lifting the Veil: The Surgeons Role in Quality Initiatives in Surgical Oncology • Room E450b
4-6 pm Value-based Surgical Oncology Care • Room E350	3:15-4 pm Ice Cream Break, View Exhibits/Posters/Fellows & Resident's Lounge; New Member Reception in EH Theater; Hall Closing • Exhibit Hall D1	3:15-4:45 pm International Colorectal Cancer Consortia: Where Do We Stand? • Room E451b
	4-6 pm Immunotherapy and Breast Cancer (MOC) • Room E450a	4:45-5 pm • Break
	4-6 pm Clinical Trials for Surgeons: Hurdles and Opportunities • Room E450b	5-5:30 pm Town Hall and Annual Business Meeting • Room E350
	4-6 pm Colorectal Parallel Session* • Room E451b	6-7:30 pm President's Reception Regency Ballroom, Hyatt Regency McCormick Place



SS2018

ANNUAL
CANCER
SYMPOSIUM

March 21-24 | Chicago, IL

WELCOME TO SSO 2018

SEE INSIDE FOR OUR
SCHEDULE-AT-A-GLANCE!

The Exceptional Surgical Oncology Experience

PHYSICIAN PAYMENTS SUNSHINE ACT

SSO is compliant with the rules and regulations of the Physician Payments Sunshine Act. As a result, there may be changes in the overall Annual Meeting structure. SSO's corporate supporters and partners are responsible for reporting indirect payments and/or transfers of value to physicians. SSO does not collect data, NPI numbers or any other information on behalf of vendors as it is their sole responsibility to maintain compliance with the Physician Payments Sunshine Act.

Get the leading case-based, clinically-relevant surgical oncology self-assessment tool

Developed by the Society of Surgical Oncology and written by more than 50 experts, **SOSAP 2.0** delivers convenient learning regardless of your career stage.

SURGICAL ONCOLOGISTS AND GENERAL SURGEONS

- Fulfill Maintenance of Certification (MOC) Part 2 requirements
- Earn 60 AMA PRA Category 1 Credits™

SURGICAL ONCOLOGY FELLOWS

- Prepare for the ABS Certification Exam in Complex General Surgical Oncology
- Answer over 270 questions that include in-depth critiques and references

Learn more and purchase at surgonc.org/ExpertEd.

Visit the SSO Membership Booth 616 to speak with a representative about SOSAP 2.0

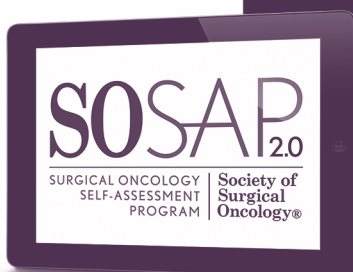

CELEBRATING 25 YEARS



Annals of Surgical Oncology



Born from a vision to promote research and education and to advance the profession of surgical oncology, the *Annals of Surgical Oncology* (ASO) has become the journal of choice for surgical oncologists around the globe.

Touting impressive metrics, ASO is one of the most cited surgical journals in the world with nearly 14,000 citations in 2016 to articles published within the last five years.¹ ASO has published two to five more times as many research articles as compared to other journals including *Journal of Surgical Oncology* and *JAMA Surgery*.¹

This Anniversary not only celebrates a distinguished history, but also the dedication of the Founding Editor-in-Chief, Charles M. Balch, MD who is entrusting ASO's editorial future to new Editor-in-Chief, Kelly M. McMasters, MD, PhD.

SSO looks forward to the future growth and impact of this distinguished journal.

SSO Society of
Surgical Oncology®

¹Balch CM, Roh M, McMasters KM, et. al. *Ann Surg Oncol*. 2018;25:1-4.



STAY ON THE CUTTING EDGE OF PRACTICE WITH AN **SSO MEMBERSHIP**

An SSO membership matters to strengthen your practice, incite better patient outcomes and build your leadership skills. An SSO membership helps you:

Attain knowledge, including information about clinical trials and translational research that will impact the way you deliver patient care.

Gain access to expert information to help you manage complex cases and controversies.

Secure opportunities to **augment your reputation** and advance your career.

Connect with a community of peers as well as worldwide cancer surgery experts.

You know what it takes to be a leader in cancer surgery, now let SSO help you achieve your goals. Commit to the SSO mission of improving multidisciplinary patient care by advancing the science, education and practice of cancer surgery worldwide and become a member today.

**SAVE
\$150**

JOIN SSO BY SATURDAY | MARCH 24

and the Society will waive your application fee –
STOP BY THE SSO MEMBERSHIP BOOTH 616
TO LEARN MORE.

SOCIETY OF SURGICAL ONCOLOGY AND THE SSO FOUNDATION PREMIER PARTNERS

The Society of Surgical Oncology and The SSO Foundation recognize the essential role that health care organizations play in furthering the mission of the Society. SSO and The SSO Foundation thank its partners for their generous support of the 71st SSO Annual Cancer Symposium and other important SSO and The SSO Foundation programs.

Support has been provided for the period of
April 1, 2017 – March 31, 2018

LEGACY

Merck & Co., Inc.

CORNERSTONE

Amgen, Inc.

Ethicon, Part of the Johnson &
Johnson Family of Companies

LEADERSHIP

Genentech, Inc.

FOUNDER

Faxitron Bioptics, LLC
Medtronic

AMBASSADOR

Pacira Pharmaceuticals, Inc.

SUPPORTER

Bristol-Meyers Squibb
Celgene Corporation
Dune Medical
John Wayne Cancer Foundation
Myriad Genetics, Inc.
RAND SRL
Sirtex
The SSO Foundation

FRIEND

American Cancer Society
Applied Medical
BARD Davol
Belmont Instrument Corporation
Bovie Medical
City of Hope National Medical Center
Clinical Genomics
Genomic Health
Hologic, Inc.
Novartis Oncology
ThermaSolutions

MOBILE ACCESS FOR **SSO 2018**

Search “**SSO Events**” in Google Play, App Store, BlackBerry World and Windows Phone Store to download the free SSO Events mobile app!

The SSO Events mobile app allows you access to complete conference information for SSO 2018. Be sure to download the app on your phone or tablet for one-touch access to the following:

- Poster, video and oral abstracts
- Interactive schedule
- Up-to-the-minute Symposium updates
- Speaker and moderator listings, photos and bios
- Exhibitor listings, categories and information
- Interactive maps
- Committee meeting schedule
- Audience response polling in select sessions

Enhance Your App Experience

Visit the app and enter your email address to log in and utilize additional features that allow you to:

- Create your own schedule
- Take notes during sessions
- Identify favorite exhibitors

SSO2018.ORG

Alternately, you can access the program schedule and all mobile app content at **eventmobi.com/SSO2018**. SSO is pleased to provide this enhanced mobile-friendly resource that allows you to view complete details about the Symposium’s education program, add sessions to your personal calendar and search by track, type, presenter or moderator.

TABLE OF CONTENTS

Schedule at a GlanceInside front cover

Mobile Access for SSO 2018	6
Daily Events.....	8
Reorganized and Expanded SSO 2018 Program	13
General Information	14
Meeting Highlights.....	25
Education Information	31
SSO and The SSO Foundation Partners and Supporters	32
ACGME Core Competencies.....	34
MOC Part 2 Self-Assessment Opportunities.....	35
Wednesday Program.....	36
Thursday Program.....	38
James Ewing Lecture.....	43
John Wayne Clinical Research Lecture.....	44
Friday Program.....	48
The Charles M. Balch, MD, Distinguished Service Award.....	50
James Ewing Layperson's Award.....	51
SSO Presidential Address.....	53
The Great Debates I.....	57
Quick Shot Sessions	58
Saturday Program	64
American Cancer Society/SSO Basic Science Lecture.....	67
Clinical and Young Investigator Award Presentations	68
The Great Debates II.....	69
Quick Shot Sessions	69
President's Reception	73
Town Hall and Annual Business Meeting.....	74
Global Partner Posters	75
Scientific Posters.....	79
Disclosure Information.....	80
Industry Forum	81
Exhibit Hall Theater Presentations	81
Exhibits	82
Faculty Index	94
Convention Center and Exhibit Hall Maps.....	98
Contribute to The SSO Foundation	102

DAILY EVENTS

For complete SSO 2018 Committee Meeting schedule and locations, please refer to the SSO Events mobile app. All locations are at the McCormick Place Lakeside Center unless otherwise noted.

WEDNESDAY, MARCH 21

- 6:30 am-6 pm **Registration Open**
Exhibit Hall D1 Foyer
- 7 am-6 pm **Speaker Ready Room Open**
Room E257
- 8 am-12 pm **Pre-Meeting Course**
(Ticket Required)
Resident Oncology Forum
Room E253cd
- 9:30 am-12 pm **Pre-Meeting Course**
(Ticket Required)
Complex General Surgical Oncology (CGSO) Board Exam Review Session
Room E253ab
- 1-5 pm **Pre-Meeting Course**
(Ticket Required)
Fellows Institute II: Practical Aspects of Starting a Surgical Oncology Career
Room E253ab
- 1-5 pm **Pre-Meeting Course**
(Ticket Required)
Practice-Changing Papers in Surgical Oncology in 2017 (MOC)
Room E253cd

THURSDAY, MARCH 22

- 6 am-6:30 pm **Registration Open**
Exhibit Hall D1 Foyer
- 6 am-6:30 pm **Speaker Ready Room Open**
Room E257
- 6:45-7:45 am **Industry Forum (Genentech): Presurgical Considerations for Patients with Early Breast Cancer**
Room E353c
- 8-9:30 am **Case Presentations with Professors and Fellows**
Room E350
- 8-9:30 am **Novel Clinical Trials in Breast Cancer**
Room E450a
- 8-9:30 am **Contemporary Management of Thyroid Cancer (MOC)**
Room E450b
- 8-9:30 am **Managing the Future Liver Remnant**
Room E451b
- 9:30 am-4 pm **Exhibit Hall and Fellows & Residents Lounge Open**
Exhibit Hall D1

9:30-10:15 am	Exhibit Hall Opening Refreshment Break <i>Exhibit Hall D1</i>
9:40-10:10 am	Thursday Exhibit Hall Video Abstracts <i>Exhibit Hall Theater, Exhibit Hall D1</i>
10:15 am-12:15 pm	The Future of Surgical Oncology Reimbursement in the Era of Bundled Payments <i>Room E350</i>
10:15 am-12:15 pm	Breast Parallel Session 1 <i>Room E450a</i>
10:15 am-12:15 pm	Quality Improvement/Clinical Outcomes Parallel Session <i>Room E450b</i>
10:15 am-12:15 pm	Robotic Assisted Minimally Invasive Surgical Oncology (MOC) <i>Room E451b</i>
12:15-1:15 pm	Exhibit Hall Lunch (See details on page 21) <i>Exhibit Hall D1</i>
12:30-1 pm	Poster Grand Rounds (See details on page 23) <i>ePoster Monitors, Exhibit Hall D1</i>
12:30-1:15 pm	Exhibit Hall Theater Presentation (Amgen): Clinical Considerations for Treatment in Advanced Melanoma <i>Exhibit Hall Theater, Exhibit Hall D1</i>
1:15-1:30 pm	Welcome and Announcements <i>Room E354b</i>
1:30-2:15 pm	James Ewing Lecture <i>Room E354b</i>
2:15-3 pm	John Wayne Clinical Research Lecture <i>Room E354b</i>
3-4 pm	Refreshment Break in the Exhibit Hall <i>Exhibit Hall D1</i>
3:15-3:45 pm	Poster Grand Rounds (See details on page 23) <i>ePoster Monitors, Exhibit Hall D1</i>
4-6 pm	Value-based Surgical Oncology Care <i>Room E350</i>
4-6 pm	Controversial Topics in Breast Surgical Management to Improve Outcomes (MOC) <i>Room E450a</i>
4-6 pm	Endocrine Parallel Session <i>Room E450b</i>
4-6 pm	Hepato-pancreato-biliary Parallel Session 1 <i>Room E451b</i>
6-7:30 pm	Welcome Reception in the Exhibit Hall <i>Exhibit Hall D1</i>

FRIDAY, MARCH 23

6 am-4 pm	Registration Open <i>Exhibit Hall D1 Foyer</i>
6 am-6 pm	Speaker Ready Room Open <i>Room E257</i>
6:45-7:45 am	Meet the Professor Breakfasts (Ticket Required) <i>For full schedule and locations, see page 48.</i>
7-7:55 am	Poster Contest Grand Rounds <i>Exhibit Hall D1 Foyer</i>
8-8:45 am	Plenary I <i>Room E354b</i>
8:45-9 am	The Charles M. Balch, MD, Distinguished Service Award & James Ewing Layperson's Award <i>Room E354b</i>
9-9:45 am	SSO Presidential Address <i>Room E354b</i>
9:45 am-4 pm	Exhibit Hall and Fellows & Residents Lounge Open <i>Exhibit Hall D1</i>
9:45-10:15 am	Refreshment Break in the Exhibit Hall <i>Exhibit Hall D1</i>
9:50-10:10 am	Friday Exhibit Hall Video Abstracts <i>Exhibit Hall Theater, Exhibit Hall D1</i>
10:15 am-12:15 pm	Current Management of Nodal Metastases in Patients with Melanoma (MOC) <i>Room E350</i>
10:15 am-12:15 pm	Breast Parallel Session 2 <i>Room E450a</i>
10:15 am-12:15 pm	Hepato-pancreato-biliary Parallel Session 2 <i>Room E450b</i>
10:15 am-12:15 pm	Adaptation of New Technology for Rectal Cancer: Do I Need New Tools in My Toolbox? (MOC) <i>Room E451b</i>
12:15-1:15 pm	Exhibit Hall Lunch (See details on page 21) <i>Exhibit Hall D1</i>
12:30-1 pm	Poster Grand Rounds (See details on page 23) <i>ePoster Monitors, Exhibit Hall D1</i>
1:15-2 pm	Plenary II <i>Room E354b</i>
2-3:15 pm	The Great Debates I <i>Room E354b</i>
2:15-3:15 pm	Melanoma Quick Shot Abstracts <i>Room E350</i>
2:15-3:15 pm	Breast Quick Shot Abstracts <i>Room E450a</i>

2:15-3:15 pm	Quality Improvement/Clinical Outcomes Quick Shot Abstracts <i>Room E450b</i>
2:15-3:15 pm	Colorectal Quick Shot Abstracts <i>Room E451b</i>
3:15-4 pm	Exhibit Hall Ice Cream Break <i>Exhibit Hall D1</i>
3:15-4 pm	SSO New Member Reception <i>Exhibit Hall Theater</i>
4-6 pm	Melanoma Parallel Session <i>Room E350</i>
4-6 pm	Immunotherapy and Breast Cancer (MOC) <i>Room E450a</i>
4-6 pm	Clinical Trials for Surgeons: Hurdles and Opportunities <i>Room E450b</i>
4-6 pm	Colorectal Parallel Session <i>Room E451b</i>

SATURDAY, MARCH 24

6 am-2 pm	Registration Open <i>Exhibit Hall D1 Foyer</i>
6:45-7:45 am	Meet the Professor Breakfasts (Ticket Required) For full schedule and locations, see page 64.
7 am-3 pm	Speaker Ready Room Open <i>Room E257</i>
8-9:30 am	Disparities Parallel Session <i>Room E350</i>
8-9:30 am	Local & Regional Therapy Options for Primary and Metastatic Tumors in Hepatobiliary Surgery (MOC) <i>Room E450a</i>
8-9:30 am	My Patient Read the Internet: Molecular Markers and Novel Treatments for Colorectal Cancer (MOC) <i>Room E450b</i>
8-9:30 am	Subtype-Specific Biology and Treatment of Soft Tissue Sarcomas (MOC) <i>Room E451b</i>
9:30-9:45 am	Refreshment Break <i>Exhibit Hall D1 Foyer</i>
9:45-10:30 am	American Cancer Society/SSO Basic Science Lecture <i>Room E450b</i>
10:30-11:05 am	Clinical and Young Investigator Award Presentations <i>Room E450b</i>

11:05 am-12:30 pm	The Great Debates II <i>Room E450b</i>
11:15 am-12:15 pm	HPB and Upper GI Quick Shot Abstracts <i>Room E450a</i>
11:15 am-12:15 pm	Sarcoma Quick Shot Abstracts <i>Room E451b</i>
12:30-1:30 pm	Lunch on own
12:30-1:30 pm	Surgical Clinical Trials Investigator Meeting <i>Rooms E253a and E253b</i>
1:30-3 pm	Upper Gastrointestinal Parallel Session <i>Room E450a</i>
1:30-3 pm	Top Rated Videos <i>Room E450b</i>
1:30-3 pm	Sarcoma Parallel Session <i>Room E451b</i>
3-3:15 pm	Refreshment Break <i>Exhibit Hall D1 Foyer</i>
3:15-4:45 pm	Surgical Cyto reduction and Regional Chemotherapy: State of the Science <i>Room E450a</i>
3:15-4:45 pm	Lifting the Veil: The Surgeons Role in Quality Initiatives in Surgical Oncology <i>Room E450b</i>
3:15-4:45 pm	International Colorectal Cancer Consortia: Where Do We Stand? <i>Room E451b</i>
5-5:30 pm	Town Hall & Annual Business Meeting <i>Room E350</i>
6-7:30 pm	President's Reception <i>Regency Ballroom, Hyatt Regency McCormick Place</i>

PRESIDENT'S RECEPTION

6-7:30 pm, Saturday, March 24

(Ticket required)

Regency Ballroom, Hyatt Regency McCormick Place

SSO President Dr. Kelly M. McMasters invites you to join him Saturday evening for cocktails and hors d'oeuvres. This event will provide an excellent opportunity for you to connect with friends and colleagues to discuss news from the meeting and make plans to reconnect next year in San Diego.

REORGANIZED AND EXPANDED PROGRAM AT SSO 2018!

What's different about SSO 2018? We've taken the more important aspects of past meetings and expanded them to create a dynamically new experience designed to further your professional knowledge.

Expanded Program

This year's meeting features an expanded program with an 88% increase in oral abstracts and a 36% increase in overall sessions compared to last year. SSO 2018 features new Quick Shot Abstract sessions, which highlight top abstracts by disease-site in a shorter, engaging format.

Clustered Disease Site Tracks

New for this year, the Scientific Program Committee has reorganized and clustered sessions by disease-specific tracks. As a result, attendees will be able to maximize daily schedules and attend sessions that present the next generation of surgical oncology research.

Fellows & Residents Lounge

Dedicated for use by fellow and resident SSO Members, the lounge is located in the Exhibit Hall. The lounge will feature informal discussions with prominent SSO leaders. The lounge can also be utilized as a space to network with other fellows and residents and relax during sessions. Internet access and refreshments will be provided throughout the day.

Not an SSO member? Fellows and residents may complete an application for membership at the SSO Membership Booth 616.

SELFIE STATION

Capture a photo with your colleagues at SSO's Selfie Stations. Station A is located in the Registration Foyer and Station B is located at SSO Membership Booth 616. Be sure to post your photo on Twitter and use [#SSO2018](#).

2017-2018

SSO OFFICERS & EXECUTIVE COUNCIL

Officers

President	Kelly M. McMasters, MD, PhD (2018)
President-Elect	Armando E. Giuliano, MD (2018)
Vice-President	David L. Bartlett, MD (2018)
Secretary	Douglas S. Tyler, MD (2019)
Treasurer	Sandra Wong, MD (2020)

Executive Council Members

Daniel G. Coit, MD (2018)	Immediate Past President
Jeffrey A. Drebin, MD, PhD (2018)	Past President
Russell S. Berman, MD (2018)	
Ned Z. Carp, MD (2019)	
James R. Howe, MD (2019)	
Kelly Hunt, MD (2020)	
Hector Martinez Said, MD (2018)	
Kevin K. Roggin, MD (2020)	
Elin R. Sigurdson, MD, PhD (2018)	
Julie Ann Sosa, MD (2019)	

Councilors-at-Large

Karl Y. Bilimoria, MD (2019)
Julie A. Margenthaler, MD (2018)
Jonathan S. Zager, MD (2020)

Ex Officio

Executive Director	M. Eileen Widmer, CAE, CFRM
President, The SSO Foundation	Monica Morrow, MD (2020)
Editor, <i>Annals of Surgical Oncology</i>	Charles M. Balch, MD (2018)

GET SSO 2018 ONSITE UPDATES AND INFORMATION

Be sure to leverage the **SSO Events mobile app** or **eventmobi.com/sso2018**, and follow **@SocSurgOnc** on Twitter using the hashtag **#SSO2018** for up-to-date information!

2017-2018

THE SSO FOUNDATION BOARD OF DIRECTORS

Officers

Monica Morrow, MD (2020)	President
Ronald J. Weigel, MD, PhD (2018)	Vice President
Robert C.G. Martin, II, MD (2018)	Treasurer
M. Eileen Widmer, CAE, CFRM	Executive Vice President

Board Of Directors

Kelly M. McMasters, MD, PhD (2019)	SSO President
Daniel G. Coit, MD (2018)	SSO Immediate Past President
Armando E. Giuliano, MD (2018)	SSO President-Elect
H. Richard Alexander, Jr., MD (2018)	
Steven A. Curley, MD (2018)	
Mehra Golshan, MD (2020)	
Martin J. Heslin, MD (2019)	
Scott H. Kurtzman, MD (2019)	
Charles A. Staley, MD (2018)	
Mark S. Talamonti, MD (2020)	
Thomas Weber, MD (2020)	

Staff

M. Eileen Widmer, CAE, CFRM	Executive Vice President
Jeanette Ruby	Director, Corporate Partnerships & Donor Relations
Michelle H. Anderson, CPA, MBA	Controller

SSO STAFF

Executive Director	M. Eileen Widmer, CAE, CFRM
Associate Executive Director, Administration	Karen A. Hurley, MA, CAE
Associate Executive Director, Strategic Partnerships and Programs	Charmaine J. Cummings, RN, PhD
Director, Corporate Partnerships & Donor Relations	Jeanette Ruby
Director, Education	Patti Stella, CHCP
Director, Marketing & Communications	Karen Christensen Araujo, MA
Controller	Michelle Anderson, CPA, MBA
Assistant Director, Education & Meetings	Rebecca A. Williams, CMP
Manager, CME & Online Learning	Alanna Persaud
Manager, Global Outreach & Special Programs	Ana Olivares
Manager IT Projects	James Trigueros, MA
Education Coordinator	Kelley Gazer
Education Coordinator	Patty Orlowski
Membership Services Coordinator	Yazmin Wheelock
Operations Coordinator	Kathy Sampson
Executive Assistant	Erin Fleming

HEADQUARTERS OFFICE

9525 W. Bryn Mawr Ave., Suite 870
Rosemont, IL 60018
P: (847) 427-1400 • F: (847) 427-1411
sso@surgonc.org

ANNUAL MEETING & TRADESHOW TEAM

Senior Vice President, Healthcare Events	Sue Deveaux
Senior Meetings Manager	Kayce Henderson
Meetings Coordinator	McKenna Weipert
Sales Account Manager, Healthcare Sector	Darnella Bradley
Senior Manager, Exhibit Operations	Shirley Harris, CEM
Senior Registration Account Manager	Anna Roscigno
Housing Account Manager	Carol Harris

2017-2018

SCIENTIFIC PROGRAM COMMITTEE

Charles R. Scoggins, MD, MBA – Chair (2018)

Sanjay P. Bagaria, MD – Vice Chair (2018)

Rebecca A. Auer, MD, MSc (2019)

Carlton C. Barnett, Jr., MD (2020)

Robert J. Canter, MD (2018)

Bryan M. Clary, MD (2020)

Brian J. Czerniecki, MD, PhD (2018)

Ryan C. Fields, MD (2018)

Julie E. Lang, MD (2020)

Edward A. Levine, MD (2019)

Barbara A. Pockaj, MD (2019)

Motaz Qadan, MD, PhD (2020)

Robert E. Roses, MD (2018)

Randall P. Scheri, MD (2018)

Heather L. Yeo, MD, MHS (2020)

Herbert J. Zeh, III, MD (2020)

Peter J. Allen, MD – *Ex Officio* (2018)

Keith A. Delman, MD – *Ex Officio (Training & Fellows Sub-Committees)* (2018)

Brian J. Kaplan, MD – *Ex Officio (CME)* (2018)

LOCAL ARRANGEMENTS TEAM

Mark Talamonti, MD – Chair

Daniel E. Abbott, MD

David J. Bentrem, MD

Nikolaos A. Dallas, MD

T. Clark Gamblin, MD

Sabha Ganai, MD, PhD, MPH

Michael House, MD

Nora Jaskowiak, MD

Ajay V. Maker, MD

Sam G. Pappas, MD

Paul B. Roach, MD

George I. Salti, MD

Margo C. Shoup, MD

Magesh Sundaram, MD

Susan Tsai, MD, MHS

Kiran K. Turaga, MD, MPH

Sharon Weber, MD

Katherine A. Yao, MD

Tina W. F. Yen, MD, MS

CONTINUING MEDICAL EDUCATION COMMITTEE

Brian J. Kaplan, MD, Chair (2018)

Marissa Howard-McNatt, MD Vice Chair (2018)

John Ammori, MD (2019)

Cletus Arciero, MD (2019)

Chandrakanth Are, MD, MBA (2018)

Abigail Caudle, MD, MS (2018)

Laura S. Dominici, MD (2018)

Declan Fleming, MD (2018)

David McFadden, MD (2018)

Sarah A. McLaughlin, MD (2018)

Sanjay Reddy, MD (2018)

Michael Sabel, MD (2019)

Ranjna Sharma, MD (2019)

Jason Paul Wilson, MD (2018)

Charles R. Scoggins, MD, MBA – *Ex Officio (Scientific Program Committee)* (2018)

James R. Howe, MD – *Ex Officio (Executive Council)* (2018)

ExpertEd@SSO – YOUR POST-CONFERENCE RESOURCE

ExpertEd@SSO is your post-conference destination to supplement your education with a variety of programs developed by preeminent surgical oncology thought leaders. Use ExpertEd@SSO to claim CME and MOC from attendance at sessions. Visit surgonc.org/ExpertEd.



GENERAL INFORMATION

(Listed alphabetically)

Abstract Contests

ANNUAL RESIDENT/FELLOW ESSAY AWARDS

Winners of the best Clinical Research paper and best Basic Science Research paper will be announced during the Town Hall and Annual Business Meeting on Saturday, March 24 at 5 pm.

*Supported by an independent grant from
The SSO Foundation.*

ABSTRACT POSTER CONTEST

The Society will present an award for Best Basic/Translational Research Poster and Best Clinical Research Poster at the beginning of the Great Debates II session on Saturday, March 24 at 11 am.

Please cast your votes by 4 pm on Friday, March 23. Poster Contest finalists are displayed in the Exhibit Hall D1 Foyer. Ballots were handed out at Registration check-in.

Disparities Abstracts Sub-category

Abstracts that reflect this sub-category span the complex nature of disparities as they relate to surgical oncologic care and seek to understand the nature of disparities in surgical care and the factors that influence and mitigate them. These abstracts are tagged in the Disparities Track in the SSO 2018 schedule and abstract listings within the SSO Events mobile app.

Certificate of Attendance

SSO 2018 attendees in need of a certificate of attendance must complete the SSO 2018 overall evaluation at **surgonc.org/ExpertEd**.

Committee Meetings

For complete Committee Meeting schedule and locations, please refer to the SSO 2018 schedule component of the SSO Events mobile app.

Claim CME Credit for SSO 2018 Online

Claim CME Credit for the 71st Annual Cancer Symposium Online

Claim your CME credit for the 71st Annual Cancer Symposium by logging on to surgonc.org/ExpertEd. To earn credit complete the overall meeting evaluation, choose the sessions you attended, and indicate the amount of time spent in each session. Be sure to claim your credit prior to **Friday, May 25, 2018**.

We encourage you to visit SSO's new learning management system, ExpertEd@SSO, to claim your CME credits and utilize its exciting feature to automatically send your credits to the American Board of Surgery. While you're there, be sure to browse through the online catalogue to see the many educational offerings SSO has available and coming up.

For more information about ExpertEd@SSO, please visit surgonc.org/ExpertEd. Feel free to contact education@surgonc.org with any questions.

Exhibits Showcase New Products and Solutions *Exhibit Hall D1*

Over 60 technical and scientific exhibitors will display their latest products and services in the Exhibit Hall throughout SSO 2018. SSO appreciates the support of its exhibitors and strongly encourages all registrants to visit the displays.

Exhibit Hours:

Thursday, March 22	9:30 am-7:30 pm
Friday, March 23	9:45 am-4 pm

Exhibit Hall Passport to Prizes

Visit SSO exhibitors to earn a chance to win exciting prizes!

As you make your way through the Exhibit Hall talking with exhibitors and visiting their booths, participate in Passport to Prizes and enter to win.

1. Pick up your Passport game card at registration
2. Visit at least 8 exhibiting companies and ask them to sign your Passport game card
3. Drop your completed Passport game card in the entry box located at the SSO Membership Booth 616

The prize drawings will take place at **3:45 pm on Friday at the SSO Membership Booth 616**. **Participants must be present to win!**

Prizes include:

- Apple iPad Pro with Cellular – 10.5"
- Apple Watch Series 3 with Cellular
- Fitbit Ionic Smart Watch

Exhibit Hall Theater Presentation

The Exhibit Hall Theater Presentation offer you the opportunity to interact with select exhibitors and learn about product and service innovations. See a listing of the featured exhibitors on signage at the back of Exhibit Hall D1. This session occurs on Thursday, March 22.

NOT
FOR
CREDIT

Fellows & Residents Lounge

The Fellows & Residents Lounge is an exclusive, popular space within the Exhibit Hall for fellow and resident SSO members*. The Lounge gives fellows and residents a space to network with other trainees and relax between sessions. The lounge is located in the Exhibit Hall D1 and will be open during exhibit hours. It will feature informal discussions with prominent SSO leaders.

****Not an SSO Member? Apply for membership at the SSO Membership Booth 616.***

Industry Forum

The Industry Forum features select exhibitors addressing current issues in health care. This year's one-hour non-CME breakfast session will take place on Thursday, March 22 from 6:45-7:45 am in Room E353c.

See page 81 for full details.

NOT
FOR
CREDIT

Lunch Options

Lunch vouchers are provided to each meeting registrant for use at lunch on Thursday and Friday. These vouchers can be used to offset the cost of meals in the Exhibit Hall. A variety of food will be available, including hot items, healthy meal options and beverages. The lunch voucher is located in your badge holder.

Exhibit Hall Lunch Hours

Thursday, March 22	12:15-1:15 pm
Friday, March 23	12:15-1:15 pm

Cash and credit cards will be accepted. No lunch vouchers are provided for Saturday.

JOIN SSO TODAY!

Your membership in SSO matters to your knowledge, your performance and your professional development. SSO keeps you in the forefront of your profession, which is why it is so important for you to consider an SSO membership today.

SSO offers you innovation with access to cutting edge and emerging research related to both surgical oncology in general, as well as new knowledge focused on specific disease sites.

SSO offers you applicability with extensive translational research and practical resources that allow you to implement proven best practices.

SSO offers you connectivity with access to a community of your peers as well as worldwide surgical oncology experts.

Act Now to Receive an Annual Meeting Membership Special

Join SSO by Saturday, March 24 and the Society will waive your application fee – a savings of \$150. Stop by SSO Membership Booth 616 in the Exhibit Hall to take advantage of this opportunity and to learn about the various benefits of becoming a member.

SSO MEMBERSHIP BOOTH 616

Stop by SSO Membership Booth 616 to relax in the lounge and meet colleagues. While at the booth, you may charge your phone, learn about the 25th Anniversary of *Annals of Surgical Oncology*, see a demo of ExpertEd@SSO, join or renew your membership, donate to the SSO Foundation or take a selfie at the Selfie Station.

SELFIE STATION

Capture a photo with your colleagues at SSO's Selfie Stations. Station A is located in the Registration Foyer and Station B is located at SSO Membership Booth 616. Be sure to post your photo on Twitter and use **#SSO2018**.

Photographs and Recordings

By registering for this meeting, attendees acknowledge and agree that SSO or its agents may take photographs during events and may freely use those photographs in any media for SSO purposes, including, but not limited to, news and promotional purposes.

The presentations, slides and handouts provided in this program are the property of SSO or used by permission. You may not photograph, videotape, audiotape or otherwise record or reproduce any of the presentations without express written permission from SSO. Any attendee believed to be violating this restriction will be removed from the session and may be prohibited from participating in further SSO meetings.

**NO PERSONAL AUDIO OR VIDEO RECORDERS
ARE ALLOWED IN MEETING ROOMS.**

Poster Grand Rounds

During these interactive sessions, top scoring poster presentations will be highlighted by moderators in each disease-site category. Discussion and comments will be encouraged in the Grand Rounds. See the SSO Events mobile app for full SSO 2018 information and schedule.

Poster Presentations

See full details starting on page 79.



Speaker Ready Room

The Speaker Ready Room is located in Room E257 and is available to all program participants.

SSO 2018 Virtual Meeting

Miss a session during SSO 2018? Wondering how you can still get access to the cutting-edge material presented at the meeting? As a registered conference attendee, you will be able to access SSO 2018 recordings at no additional charge.

*To access the SSO 2018 Virtual Meeting,
visit **surgonc.org/ExpertEd***

Get the leading case-based, clinically-relevant surgical oncology self-assessment tool

Developed by the Society of Surgical Oncology and written by more than 50 experts, **SOSAP 2.0** delivers convenient learning regardless of your career stage.

SURGICAL ONCOLOGISTS AND GENERAL SURGEONS

- Fulfill Maintenance of Certification (MOC) Part 2 requirements
- Earn 60 AMA PRA Category 1 Credits™

SURGICAL ONCOLOGY FELLOWS

- Prepare for the ABS Certification Exam in Complex General Surgical Oncology
- Answer over 270 questions that include in-depth critiques and references

Learn more and purchase at surgonc.org/ExpertEd.

Visit the SSO Membership Booth 616 to speak with a representative about SOSAP 2.0

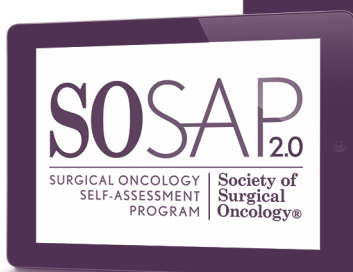

MEETING HIGHLIGHTS



James Ewing Lecture: Hormonal Control of Cancers: Something Old and Something New

1:30-2:15 pm, Thursday, March 22

Room E354b

B. Mark Evers, MD

See page 43 for full details.

Supported by an independent grant from The SSO Foundation.



John Wayne Clinical Research Lecture: Melanoma, a Kaleidoscopic View

2:15-3 pm, Thursday, March 22

Room E354b

Alexander M.M. Eggermont, MD, PhD

See page 44 for full details.

Supported by an independent grant from the John Wayne Cancer Foundation.



Harvey Baker Traveling Fellow Award

10:27 am, Friday, March 23

Room E450b, Hepato-Pancreato-Biliary Parallel Session 2

Roheena Z. Panni, MD

The Society congratulates Dr. Panni, who is attending SSO 2018 as the recipient of this award for the following abstract:

57: Reprogramming Tumor Microenvironment to Improve Responses to Immunotherapy in Pancreatic Cancer

See the SSO Events mobile app for full SSO 2018 presenter and abstract information.

Supported by an independent grant from The SSO Foundation.



The Charles M. Balch, MD, Distinguished Service Award

8:45-8:55 am, Friday, March 23

Room E354b

Norman Wolmark, MD, and Bernard Fisher, MD

In recognition of their work with the National Surgical Adjuvant Breast and Bowel Project (NSABP).

See page 50 for full details.



James Ewing Layperson's Award

8:55-9 am, Friday, March 23

Room E354b

Alex Kimura, Sam Kimura and Taylor Shorten

Sharing America's Marrow



In recognition of their tireless efforts to raise awareness and encourage people to join the bone marrow donor registry to potentially donate to a patient in need through their non-profit, *Sharing America's Marrow* (SAM). See page 51 for full details.



**American Cancer Society/SSO
Basic Science Lecture: Mixing It
Up: Rewiring the Transcriptome
of Pancreatic Cancer Cells
and Surgeon Scientists**

9:45-10:30 am, Saturday, March 24

Room E450b

Steven D. Leach, MD

See page 67 for full details.

Supported by an independent educational grant from the American Cancer Society.

Clinical and Young Investigator Award Presentations

10:30-11:05 am, Saturday, March 24

Room E450b

Be sure to attend this year's presentation of Clinical Investigator Award (CIA) and Young Investigator Award (YIA) recipients to hear the results of their research efforts. Recipients of the 2018-2020 CIA and the 2018 Donald L. Morton YIA in Melanoma will also be announced. See page 68 for full details.

2018 INTERNATIONAL CAREER DEVELOPMENT EXCHANGE PARTICIPANTS

SSO 2018 marks the fifth year for the International Career Development Exchange (ICDE) program. The ICDE program provides support for up-and-coming surgical oncologists, with leadership potential, who are members of an SSO Partner Society. In addition to attending SSO 2018, the ICDE recipients will have the opportunity to visit up to two U.S. based institutions to observe procedures and enhance their knowledge. ICDE recipients have been paired with SSO members, who will serve as hosts and mentors, with the intent that long-term relationships are developed in order to help improve cancer care in other countries.



Marcus Kodama Pertille Ramos, MD, MS joins us on behalf of the **Brazilian Society of Surgical Oncology**. Dr. Kodama specializes in gastric cancer at the Cancer Institute, University of Sao Paulo Medical School in Sao Paulo, Brazil.



Francis Zih, MD, MSc, FRCSC joins us on behalf of the **Canadian Society of Surgical Oncology**. Dr. Zih specializes in colorectal cancer at Surrey Memorial Hospital in Vancouver, British Columbia, Canada.



Xiaopeng Hao, MD joins us on behalf of the **Chinese Society of Clinical Oncology**. Dr. Hao specializes in breast cancer at PLA 3017 Hospital in Beijing, China.



Michael Kelly, BA, MB, BCh, BAO, (Hons. TCD), MRCSI, MCh joins us on behalf of the **European Society of Surgical Oncology**. Dr. Kelly specializes in colorectal cancer at St. Vincent's University Hospital in Dublin, Ireland.



Maheswaran Satishkumar, MBBS, MS, MCH joins us on behalf of the **Indian Society of Surgical Oncology**. Dr. Satishkumar specializes in gastrointestinal cancer at the Madurai Medical College in Chennai, Tamilnadu, India.



Hideya Kashihara, MD, PhD, joins us on behalf of the **Japanese Society of Gastroenterological Surgery**. Dr. Kashihara specializes in gastrointestinal cancer at Tokushima University in Tokushima, Japan.



Young Suk Park, MD joins us on behalf of the **Korean Society of Surgical Oncology**. Dr. Park specializes in gastric cancer at the Seoul National University Bundang Hospital in Seoul, Korea.



Nereida Esparza-Arias, MD joins us on behalf of the **Sociedad Mexicana de Oncología**. Dr. Esparza-Arias specializes in breast cancer at the Instituto Nacional de Cancerología in Mexico City, Mexico.

Fellows & Residents Lounge

The Fellows & Residents Lounge is an exclusive, popular space within the Exhibit Hall for fellow and resident SSO members*. The Lounge gives fellows and residents a space to network with other trainees and relax between sessions. Located in the Exhibit Hall and open during exhibit hours, the lounge will feature informal discussions with prominent SSO leaders.

****Not an SSO Member? Apply for membership at the SSO Membership Booth 616.***



EXPLORE



**AT THE SSO
MEMBERSHIP
BOOTH 616.**

**Concurrent Sessions, Quick Shot Abstracts,
The Great Debates – Can't Attend Everything?**

ExpertEd@SSO Delivers the SSO 2018 Virtual Meeting

ExpertEd@SSO is the post-SSO 2018 resource to view missed sessions and hear notable speakers a second time. Convenient to access and easy to navigate, ExpertEd@SSO records participation in virtual meeting sessions and programs for easy future reference.

In addition to the SSO 2018 Virtual Meeting, ExpertEd@SSO also offers a variety of webinars and *Annals of Surgical Oncology* journal CME activities on solid-tumor topics. These educational programs are **free to members** and CME and MOC credits are automatically transferred to the American Board of Surgery.

Visit ExpertEd@SSO at surgonc.org/ExpertEd to review the product catalog, attend a Virtual Meeting session or enroll in an educational program.

Annals of Surgical Oncology CELEBRATING 25 YEARS



FACTS & FIGURES YOU SHOULD KNOW ABOUT ASO



5,834,024
article downloads
from 2005-2016



41,238
article citations
from 2003-2017

Most Cited Surgical Oncology Journal

Number of Citations



**AVERAGE
REVIEW
TIME IS**

**23
DAYS**

Notable Volume of Solid Tumor and Translational Research Publications

Volume of Published Articles
by Topic (2005 - 2017)

1-YEAR
2016
IMPACT
FACTOR

4.041

5-YEAR
2016
IMPACT
FACTOR

4.392

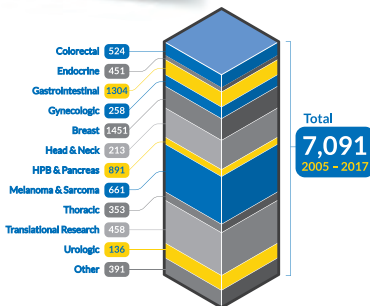

Learn more about publishing in ASO.
Visit **ANNSURGONCOL.ORG** for more information.

SSO Society of
Surgical Oncology®

EDUCATION INFORMATION

Target Audience

This activity is intended for all surgeons and other health care professionals who are involved in the treatment of patients with cancer.

Overall Educational Objectives

- Summarize recent updates and current controversies in the multidisciplinary management of patients with breast cancer, melanoma, sarcoma, pancreas and hepatobiliary malignancies, esophageal cancer, thyroid, adrenal cancer, gastric cancer, colorectal cancer, neuroendocrine tumors, and peritoneal surface malignancies.
- Identify advances in basic and translational sciences and demonstrate an understanding of prognostic and predictive assays as applicable to cancer care.
- Understand the rationale for neoadjuvant therapy and/or genetic testing in the context of personalized cancer care.
- Evaluate the goals of cost, value, and quality as applied to cancer care.
- Understand novel techniques in cancer surgery.



Accreditation

The Society of Surgical Oncology (SSO) is accredited by the Accreditation Council for Continuing Medical Education (ACCME) to provide continuing medical education for physicians.

Designation

The Society of Surgical Oncology (SSO) designates this live activity for a maximum of 27.5 *AMA PRA Category 1 Credits™*. Physicians should claim only the credit commensurate with the extent of their participation in the activity.

Acknowledgement

Please see page 32 for full supporter information. Complete information will be provided to participants prior to the start of the activity.

Disclaimer

The primary purpose of the SSO Annual Meeting is educational. Information, as well as technologies, products and/or services discussed, are intended to inform participants about the knowledge, techniques and experiences of specialists who are willing to share such information with colleagues. A diversity of professional opinions exists in the specialty and the SSO disclaims any and all liability for damages to any individual attending this conference and for all claims which may result from the use of information, technologies, products and/or services discussed at the conference.

SSO AND THE SSO FOUNDATION PARTNERS AND SUPPORTERS

Our Partners

This activity is supported, in part, by independent educational grants. The Society of Surgical Oncology (SSO) and The SSO Foundation gratefully acknowledge the following organizations for their contributions:

American Cancer Society

Supporter of the American Cancer Society/SSO Basic Science Lecture, *Mixing It Up: Rewiring the Transcriptome of Pancreatic Cancer Cells and Surgeon Scientists*

Amgen, Inc.

Partial supporter of the Melanoma/Sarcoma Track

Bristol-Myers Squibb

Partial supporter of the Melanoma/Sarcoma Track

Celgene Corporation

Partial supporter of the SSO Annual Cancer Symposium

Ethicon, Part of the Johnson & Johnson Family of Companies

Partial supporter of the Colorectal Track
Partial supporter of the Gastrointestinal/
Hepato-pancreato-biliary Track

Genomic Health

Partial supporter of the Breast Track

John Wayne Cancer Foundation

Supporter of the Thursday John Wayne Clinical Research Lecture, *Melanoma, a Kaleidoscopic View*

Merck & Co., Inc.

Supporter of the Immunotherapy and Breast Cancer Symposium, Partial supporter of the Melanoma Track

Myriad Genetics, Inc.

Partial supporter of the Breast Track

Novartis Oncology

Partial supporter of the Melanoma/Sarcoma Track

The SSO Foundation

Supporter of the James Ewing Lecture, Harvey Baker Traveling Fellow Award, Annual Resident/Fellow Essay Awards, and the Clinical & Young Investigator Awards Session

Our Sponsors

SSO gratefully acknowledges the following organizations for their sponsorship commitments:

Amgen, Inc.

Sponsor of the Hotel Key Card, Premium SSO Program Guide Listing, and the Thursday Exhibit Hall Theater Presentation: *Clinical Considerations for Treatment in Advanced Melanoma*

City of Hope National Medical Center

Sponsor of the SSO Program Guide Inside Back Cover Advertisement and Sponsor of the Premium SSO Program Guide Listing

Clinical Genomics

Thursday Welcome Reception Host: Windy City Collection

Ethicon, Part of the Johnson & Johnson Family of Companies

Thursday Welcome Reception Host: Magnificent Mile Collection and Sponsor of the SkyBridge Window Clings

Genentech, Inc.

Sponsor of the Thursday Industry Forum: *Pre-surgical Considerations for Patients with Early Breast Cancer*

Medtronic, Inc.

Thursday Welcome Reception Host: Chi-Town Station

RAND SRL and Perfusion.com

Sponsor of the SSO Program Guide Back Cover Advertisement

As of February 13, 2018. Complete information will be provided to participants prior to the activity.

SSO MEMBERSHIP BOOTH 616

Stop by SSO Membership Booth 616 to relax in the lounge and meet colleagues. While at the booth, you may charge your phone, learn about the 25th Anniversary of *Annals of Surgical Oncology*, see a demo of ExpertEd@SSO, join or renew your membership, donate to the SSO Foundation or take a selfie at the Selfie Station.

ACGME CORE COMPETENCIES

The 2018 scientific offerings assist the physician with the six core competencies first adopted by the Accreditation Council for Graduate Medical Education (ACGME) and the American Board of Medical Specialties (ABMS). Attendees are encouraged to select areas of interest from the program which will enhance their knowledge and improve the quality of patient care.

1. **Patient Care:** Provide care that is compassionate, appropriate, and effective treatment for health problems and to promote health.
2. **Medical Knowledge:** Demonstrate knowledge about established and evolving biomedical, clinical and cognate sciences and their application in patient care.
3. **Interpersonal and Communication Skills:** Demonstrate skills that result in effective information exchange and teaming with patients, their families, and professional associates (e.g., fostering a therapeutic relationship that is ethically sound, uses effective listening skills with non-verbal and verbal communication; working as both a team member and at times a leader).
4. **Professionalism:** Demonstrate a commitment to carrying out professional responsibilities, adherence to ethical principles, and sensitivity to diverse patient populations.
5. **Systems-Based Practice:** Demonstrate awareness of and responsibility to larger context and systems of health care. Be able to call on system resources to provide optimal care (e.g., coordinating care across sites or serving as the primary care manager when care involves multiple specialties, professions or sites).
6. **Practice-Based Learning and Improvement:** Able to investigate and evaluate their patient care practices, appraise, and assimilate scientific evidence and improve their practice of medicine.

MAINTENANCE OF CERTIFICATION (MOC) PART 2 SELF-ASSESSMENT OPPORTUNITIES

Self-assessment credit that may be applied towards Part 2 of the ABS MOC program will be offered for one pre-meeting course and 10 symposia occurring within the educational tracks listed below.

Pre-Meeting

- Practice-Changing Papers in Surgical Oncology in 2017 *separate registration is required

Breast

- Controversial Topics in Breast Surgical Management to Improve Outcomes
- Immunotherapy and Breast Cancer

Colorectal

- Adaptation of New Technology for Rectal Cancer: Do I Need New Tools in My Toolbox?
- My Patient Read the Internet: Molecular Markers and Novel Treatments for Colorectal Cancer

Gastrointestinal (HPB/Pancreas)

- Managing the Future Liver Remnant
- Robotic Assisted Minimally Invasive Surgical Oncology
- Local & Regional Therapy Options for Primary and Metastatic Tumors in Hepatobiliary Surgery

Melanoma and Sarcoma

- Current Management of Nodal Metastases in Patients with Melanoma
- Subtype-Specific Biology and Treatment of Soft Tissue Sarcomas

Other Surgical Oncology

- Contemporary Management of Thyroid Cancer

For more information on each of the sessions listed above please utilize the **SSO Events Mobile App** or visit **SSO2018.ORG** and select "MOC Information" listed under "Program" on the main menu.

WEDNESDAY PRE-MEETING

Residents Oncology Forum

Separate Registration & Fee Required

8 am-12 pm, Wednesday, March 21

Room E253cd

Moderators: Vance Sohn, MD and
Brian Bednarski, MD

Faculty:

Brian K. Bednarski, MD

*University of Texas MD Anderson Cancer Center,
Houston, TX*

Edie Y. Chan, MD

Rush University, Chicago, IL

Callisia N. Clarke, MD

Medical College of Wisconsin, Milwaukee, WI

Nikolaos A. Dallas, MD

AMG Surgical Specialties, Chicago, IL

Lucy M. De La Cruz, MD

*University of Pennsylvania, Perelman School of Medicine,
Philadelphia, PA*

Paxton V. Dickson, MD

*University of Tennessee Health Science Center,
Memphis, TN*

Ajay V. Maker, MD

*University of Illinois at Chicago, Creticos Cancer Center,
Chicago, IL*

Kristen P. Massimino, MD

Providence Cancer Institute, Portland, OR

WEDNESDAY PRE-MEETING

Complex General Surgical Oncology (CGSO) Board Exam Review Session

Separate Registration & Fee Required

9:30 am-12 pm, Wednesday, March 21

Room E253ab

Moderators: Motaz Qadan, MD, PhD and
Heather L. Yeo, MD, MHS

Faculty:

Christina V. Angeles, MD

Dartmouth-Hitchcock Medical Center, Lebanon, NH

Genevieve M. Boland, MD, PhD

Massachusetts General Hospital, Boston, MA

Michael R. Cassidy, MD

Boston University School of Medicine, Boston, MA

Jeremy L. Davis, MD

National Institutes of Health, Bethesda, MD

Ann Y. Lee, MD

NYU, New York, NY

Michael C. Lowe, MD, MA

Emory University School of Medicine, Atlanta, GA

Carrie Y. Peterson, MD, MS

Medical College of Wisconsin, Milwaukee, WI

Lee Starker, MD, PhD

Atlantic Health, Morristown, NJ

Heather L. Yeo, MD, MHS

NYP-Weill Cornell Medicine, New York, NY

WEDNESDAY PRE-MEETING

Fellows Institute II: Practical Aspects of Starting a Surgical Oncology Career

Separate Registration & Fee Required

1-5 pm, Wednesday, March 21

Room E253ab

Moderators: Keith A. Delman, MD and Sarah A. McLaughlin, MD

Faculty:

Ronald P. DeMatteo, MD

The Perelman School of Medicine, University of Pennsylvania, Philadelphia, PA

Jason Lina, CFA, CFP, MBA

Resource Planning Group, Atlanta, GA

Galen Perdakis, MD

Vanderbilt University, Nashville, TN

Mitchell C. Posner, MD

University of Chicago Medicine, Chicago, IL

Charles R. Scoggins, MD, MBA

University of Louisville, Louisville, KY

Charles A. Staley, MD

Emory University School of Medicine, Atlanta, GA

Nabil Wasif, MD, MPH

Mayo Clinic, Phoenix, AZ

WEDNESDAY PRE-MEETING

Practice-Changing Papers in Surgical Oncology in 2017 (MOC)

Separate Registration & Fee Required

1-5 pm, Wednesday, March 21

Room E253cd

Moderators: Rebecca C. Auer, MD, MSc and Sanjay P. Bagaria, MD

Faculty:

Clifford S. Cho, MD

University of Michigan Health Systems, Ann Arbor, MI

Dale Han, MD

Yale School of Medicine, New Haven, CT

Ajay V. Maker, MD

University of Illinois at Chicago, Creticos Cancer Center, Chicago, IL

Steven J. Nurkin, MD, MS

Roswell Park Cancer Institute, Buffalo, NY

Nabil Wasif, MD, MPH

Mayo Clinic, Phoenix, AZ

Lee G. Wilke, MD

University of Wisconsin School of Medicine and Public Health, Madison, WI

Geoffrey D. Young, MD, PhD

Miami Cancer Institute, Miami, FL

**Industry Forum (Genentech):
Presurgical Considerations for Patients
With Early Breast Cancer**

6:45-7:45 am, Thursday, March 22

(See page 81 for details)

Room E353c

(Breakfast Provided)

SYMPOSIUM

Case Presentations with Fellows and Professors

8-9:30 am, Thursday, March 22

Room E350

Moderators: Murray F. Brennan, MD and
V. Suzanne Klimberg, MD

Session Organizer: Aimee M. Crago, MD, PhD

Faculty:

Jennifer L. Baker, MD

Memorial Sloan Kettering Cancer Center, New York, NY

Danielle Henry

*H. Lee Moffitt Cancer Center and Research Institute,
Tampa, FL*

Scott Hurton

University of Calgary, Calgary, AB, Canada

Joseph Kim, MD

*Icahn School of Medicine at Mount Sinai Hospital,
New York, NY*

Elena P. Lamb, MD, MS

Fox Chase Cancer Center, Philadelphia, PA

Raphael Louie, MD, MPH

University of North Carolina - Chapel Hill, Chapel Hill, NC

Jennifer Sasaki, MD

Rutgers Cancer Institute of New Jersey, New Brunswick, NJ

Meredith Witten

University of Alabama Birmingham, Birmingham, AL

SYMPOSIUM

Novel Clinical Trials in Breast Cancer

8-9:30 am, Thursday, March 22

Room E450a

Moderators: Jacqueline S. Jeruss, MD, PhD and
Julie E. Lang, MD

Faculty:

E. Shelley Hwang, MD, MPH

Duke University, Durham, NC

Julie E. Lang, MD

University of Southern California, Los Angeles, CA

Funda Meric-Bernstam, MD

*University of Texas MD Anderson Cancer Center,
Houston, TX*

Victoria L. Seewaldt, MD

City of Hope, Duarte, CA

SYMPOSIUM

Contemporary Management of Thyroid Cancer (MOC)

8-9:30 am, Thursday, March 22

Room E450b

Moderators: Michael Bouvet, MD and
Randall P. Scheri, MD

Faculty:

Elizabeth G. Grubbs, MD

*University of Texas MD Anderson Cancer Center,
Houston, TX*

Lawrence Kim, MD

University of North Carolina, Chapel Hill, NC

Tracy S. Wang, MD, MPH

Medical College of Wisconsin, Milwaukee, WI

SYMPOSIUM

Managing the Future Liver Remnant

8-9:30 am, Thursday, March 22

Room E451b

Moderators: Bryan M. Clary, MD, MBA and
Kenneth K. Tanabe, MD

Faculty:

Thomas A. Aloia, MD

*University of Texas MD Anderson Cancer Center,
Houston, TX*

Carlos U. Corvera, MD

University of California San Francisco, San Francisco, CA

Erik Schadde, MD

Rush University Medical Center, Chicago, IL

Exhibit Hall Opening Refreshment Break

9:30-10:15 am, Thursday, March 22

View Exhibits & Posters

Exhibit Hall D1

VIDEO SESSION

Thursday Exhibit Hall Videos

9:40-10:10 am, Thursday, March 22

Exhibit Hall Theater, Exhibit Hall D1

Moderator: Charles R. St. Hill, MD and
Rebekah R. White, MD

Presenters:

Elliot A. Asare, MD

MD Anderson Cancer Center, Houston, TX

Naruhiko Ikoma, MD, MS

UT MDACC, Houston, TX

Calvin Ridgeway, MD

Lovelace Women's Hospital, Albuquerque, NM

SYMPOSIUM

The Future of Surgical Oncology Reimbursement in the Era of Bundled Payments

10:15 am-12:15 pm, Thursday, March 22

Room E350

Moderators: Murray F. Brennan, MD, and
Ryan C. Fields, MD

Faculty:

Herbert Chen, MD

University of Alabama, Birmingham, Birmingham, AL

Timothy J. Eberlein, MD

Washington University School of Medicine, St. Louis, MO

Martin J. Heslin, MD

University of Alabama, Birmingham, Birmingham, AL

V. Suzanne Klimberg, MD

University of Texas Medical Branch, Galveston, TX

Ryan M. Nunley, MD

Washington University Orthopedics, St. Louis, MO

Anaeze C. Offodile II, MD, MPH

*University of Texas MD Anderson Cancer Center,
Houston, TX*

Blasé N. Polite, MD, MPP

University of Chicago Medicine, Chicago, IL

Mitchell C. Posner, MD

University of Chicago Medicine, Chicago, IL

Douglas S. Tyler, MD

University of Texas Medical Branch, Galveston, TX

PARALLEL SESSION

Breast Parallel Session 1

10:15 am-12:15 pm, Thursday, March 22

Room E450a

Moderators: David R. Brenin, MD and
Julia C. Tchou, MD, PhD

Presenters:

Olivia D'Angelo

Emory University School of Medicine, Atlanta, GA

Meghan Flanagan

Memorial Sloan Kettering Cancer Center, New York, NY

NOT
FOR
CREDIT

Karineh Kazazian, MD, PhD

University of Toronto, Toronto, ON, Canada

Brigid Killelea, MD, MPH

Yale University School of Medicine, New Haven, CT

Heather Neuman

University of Wisconsin School of Medicine and Public Health, Madison, WI

Sylvia A. Reyes, MD

University of Pennsylvania, Perelman School of Medicine, Philadelphia, PA

Anouk J.M. Rombouts, MD

Radboudumc, Nijmegen, Netherlands

Lorena P. Suarez-Kelly

The Ohio State University, Columbus, OH

Audree Blythe Tadros, MD

Memorial Sloan Kettering Cancer Center, New York, NY

Kazuaki Takabe

Roswell Park Cancer Institute, Buffalo, NY

PARALLEL SESSION

**Quality Improvement/Clinical Outcomes
Parallel Session**

10:15 am-12:15 pm, Thursday, March 22

Room E450b

Moderators: David J. Bentrem, MD and
Ching-Wei Tzeng, MD

Presenters:

Rachel Adams Greenup, MD, MPH

Duke University Medical Center, Durham, NC

Lawrence M. Knab, MD

University of Pittsburgh Medical Center, Pittsburgh, PA

Anai N. Kothari, MD, MS

Loyola University Medical Center, Maywood, IL

Jason Liu

American College of Surgeons, Chicago, IL

Rebecca K. Marcus, MD

The University of Texas MD Anderson Cancer Center, Houston, TX

Shaila Merchant

Queen's University, Kingston, ON, Canada

Ali A. Mokdad, MD, MS

University of Texas Southwestern, Dallas, TX

Vi Nguyen, BS

University of California, San Diego School of Medicine, La Jolla, CA

Matthew J. Selleck, DO

Loma Linda University, Loma Linda, CA

Sarah Ponto Shubeck, MD

University of Michigan, Ann Arbor, MI

SYMPOSIUM

Robotic Assisted Minimally Invasive Surgical Oncology (MOC)

10:15 am-12:15 pm, Thursday, March 22

Room E451b

Moderators: Prejesh Philips, MD and
Herbert J. Zeh, III, MD

Faculty:

Yuman Fong, MD

City of Hope Medical Center, Duarte, CA

Melissa E. Hogg, MD, MS

University of Pittsburgh Medical Center, Pittsburgh, PA

Vivian E. Strong, MD

Memorial Sloan Kettering Cancer Center, New York, NY

Amer H. Zureikat, MD

University of Pittsburgh Medical Center, Pittsburgh, PA

Exhibit Hall Lunch

(See page 21 for details.)

12:15-1:15 pm, Thursday, March 22

View Exhibits & Posters

Exhibit Hall D1

Poster Grand Rounds

12:30-1 pm, Thursday, March 22

ePoster Monitors, Exhibit Hall D1

- Breast 1 - ePoster Station 1
- Hepato-Pancreato-Biliary - ePoster Station 2
- Endocrine - ePoster Station 3

Exhibit Hall Theater Presentation (Amgen): *Clinical Considerations for Treatment in Advanced Melanoma*

12:30-1:15 pm, Thursday, March 22

(See page 81 for details)

Exhibit Hall Theater, Exhibit Hall D1

WELCOME AND ANNOUNCEMENTS

1:15-1:30 pm, Thursday, March 22

Room E354b

Kelly M. McMasters, MD, PhD

SSO President

Charles R. Scoggins, MD, MBA

SSO 2018 Scientific Program Committee Chair

JAMES EWING LECTURE

Hormonal Control of Cancers: Something Old and Something New

1:30-2:15 pm, Thursday, March 22

Room E354b



B. Mark Evers, MD

Director, Markey Cancer Center
Professor and Vice-chair for Research,
Department of Surgery
Physician-in-Chief, Oncology Service Line
University of Kentucky, Lexington, KY

Dr. Evers was recruited to the University of Kentucky in 2009 as the Director of the Lucille P. Markey Cancer Center (MCC), Professor and Vice-chair for Research in the Department of Surgery, and Physician-in-Chief of the Oncology Service Line. Prior to his recruitment to Kentucky, Dr. Evers was a faculty member at the University of Texas Medical Branch (UTMB) in Galveston, Texas, for 20 years, where he served as Professor and Robertson-Poth Distinguished Chair in General Surgery and Director of the Sealy Center for Cancer Biology. Dr. Evers' research on GI cancers has been continuously funded by the NIH for more than 25 years, including an NIH MERIT Award and multiple R01s. He has authored more than 400 peer-reviewed publications, book chapters, and reviews, including prominent publications in *Nature*, *Cancer Cell*, and *PNAS*. In addition, he is the PI or multi-PI on 2 NCI T32 training grants and has mentored more than 80 students, fellows, and junior faculty during his career. Throughout this time, he has received more than 30 awards, including the prestigious Flance-Karl Award from the American Surgical Association. He is an elected member of the American Society of Clinical Investigation (ASCI) and the Association of American Physicians (AAP). Dr. Evers has held the positions of Secretary and President of the Society of University Surgeons, Secretary and President of the Southern Surgical Association, and Senior Director of the American Board of Surgery. He is currently Treasurer of the American Surgical Association. Dr. Evers serves on the editorial boards of 3 journals, is a past and current member of 3 NIH study sections, and acts as Associate Editor of the *Sabiston Textbook of Surgery*. In 2013, he led the efforts for NCI designation for the Markey Cancer Center.

Supported by an independent grant from The SSO Foundation.

JOHN WAYNE CLINICAL RESEARCH LECTURE

Melanoma, a Kaleidoscopic View

2:15-3 pm, Thursday, March 22

Room E354b

Alexander M.M. Eggermont, MD, PhD

Directeur Général Gustave Roussy
Professeur Oncologie, *Université Paris-Sud*, Villejuif, France



Dr. Eggermont is the Director General of Gustave Roussy Comprehensive Cancer Center, Cancer Campus Grand Paris in France. He serves as a Professor of Oncology at Paris-Sud University. Previously, he served as a Professor of Surgical Oncology from 2003-2016, and endowed chair of International Networking in Cancer Research (2011-2020) at Erasmus University MC Rotterdam. He has also served as the Joseph Maisin Chair in Oncology at Catholic University of Louvain in Belgium. Dr. Eggermont received his PhD in tumor immunology and was a fellow of the NCI Surgery Branch under S.A. Rosenberg in the United States. His specialties include immunotherapy, melanoma, sarcoma and isolated limb perfusion, drug development, advanced in vivo imaging models, and nanoparticles. He has over 700 peer-reviewed publications, plus 36 PhD theses at the Erasmus University MC. His work has been cited over 32,000 times.

Dr. Eggermont's international functions include the following: President European Academy of Cancer Sciences; President Cancer Core Europe; ECCO: Past President; EORTC: Past President, past Chairman Melanoma Group; ASCO: Past Member Board of Directors (Surgery Chair); AACR: Past Deputy Editor Clinical Cancer Research; Deutsche Krebshilfe: Chair International Jury for Comprehensive Cancer Centres Program; Unicancer: Vice-President French Federation of Cancer Centers, Chair Research; Member Board of Trustees CRUK; Member Wissenschaftsrat, Germany; European Journal of Cancer: Editor-in-Chief; and Appointed advisor to Kazakhstan Government for Cancer Care Strategic Development. In addition, Dr. Eggermont has received the Presidential Medal from Kazakhstan and Légion d'Honneur from France.

This lecture is supported by an independent grant from the John Wayne Cancer Foundation.

Refreshment Break in Exhibit Hall

3-4 pm, Thursday, March 22

View Exhibits & Posters

Exhibit Hall D1

Poster Grand Rounds

3:15-3:45 pm, Thursday, March 22

ePoster Monitors, Exhibit Hall D1

- Breast 2 - ePoster Station 1
 - Quality Improvements/Clinical Outcomes - ePoster Station 2
-
-

SYMPOSIUM

Value-Based Surgical Oncology Care

4-6 pm, Thursday, March 22

Room E350

Moderators: Michael E. Egger, MD, MPH, and
Lola Fayanju, MD, MA, MPHS

Faculty:

Daniel E. Abbott, MD

University of Wisconsin, Madison, WI

Thomas A. Aloia, MD

*University of Texas MD Anderson Cancer Center,
Houston, TX*

Karl Y. Bilimoria, MD, MS

*Feinberg School of Medicine, Northwestern University,
Chicago, IL*

Sandra L. Wong, MD, MS

Dartmouth-Hitchcock Medical Center, Lebanon, NH

SYMPOSIUM

Controversial Topics in Breast Surgical Management to Improve Outcomes (MOC)

4-6 pm, Thursday, March 22

Room E450a

Moderators: Susan J. Hoover, MD and
Mahmoud B. El Tamer, MD

Faculty:

Tanir M. Allweis, MD

Kaplan Medical Center, Mevasseret Zion, Israel

Judy C. Boughey, MD

Mayo Clinic, Rochester, MN

Nazanin Khakpour, MD

H. Lee Moffitt Cancer Center, Tampa, FL

John YS Kim, MD

Northwestern University, Chicago, IL

Tibor Kovacs, PhD

Guy's Hospital, London, England, UK

Michael S. Sabel, MD

University of Michigan, Ann Arbor, MI

PARALLEL SESSION

Endocrine Parallel Session

4-6 pm, Thursday, March 22

Room E450b

Moderators: Anthony D. Yang, MD, MS and
Tina W.F. Yen, MD, MS

Presenters:

Ian Wesley Folkert, MD

*Hospital of the University of Pennsylvania,
Philadelphia, PA*

Jace Philip Landry

LSU HSC New Orleans, Thibodaux, LA

Joon-Hyop Lee

Gil Medical Center, Incheon, Korea (the Republic of)

Alexandra G. Lopez-Aguilar, MD

*Winship Cancer Institute, Emory University Hospital,
Atlanta, GA*

Andrea Rachel Marcadis

Memorial Sloan Kettering Cancer Center, New York, NY

Paula Marincola Smith, MD

Vanderbilt University Medical Center, Nashville, TN

Veljko Strajina, MD

Mayo Clinic, Rochester, MN, Rochester, MN

Huan Yan, MD

Northshore University Health System, Evanston, IL

SELFIE STATION

Capture a photo with your colleagues at SSO's Selfie Stations. Station A is located in the Registration Foyer and Station B is located at SSO Membership Booth 616. Be sure to post your photo on Twitter and use **#SSO2018**.

PARALLEL SESSION

Hepato-pancreato-biliary Parallel Session 1

4-6 pm, Thursday, March 22

Room E451b

Moderators: Clifford S. Cho, MD and
Jennifer LaFemina, MD

Presenters:

Amanda Dann, MD

UCLA, Los Angeles, CA

Alexandra G. Lopez-Aguilar, MD

*Winship Cancer Institute, Emory University Hospital,
Atlanta, GA*

Autumn J. McRee

*Lineberger Comprehensive Cancer Center, University of
North Carolina, Chapel Hill, NC*

Andrew Douglas Newton, MD

*University of Pennsylvania, Perelman School of Medicine,
Philadelphia, PA*

Roheena Z. Panni, MD

Washington University in Saint Louis, Saint Louis, MO

Zachary Senders, MD

*University Hospitals Cleveland Medical Center,
Cleveland, OH*

Pablo Serrano, MD

McMaster University, Hamilton, ON, Canada

Eve Simoneau, MD, PhD

MD Anderson Cancer Center, Houston, TX

Robert Torphy, MD

University of Colorado, Denver, CO

Lavanya Yohanathan, MD

Mayo Clinic, Rochester, MN

WELCOME RECEPTION IN THE EXHIBIT HALL

6-7:30 pm, Thursday, March 22

Exhibit Hall D1

Join us in the Exhibit Hall for refreshments and networking as you visit the posters and exhibits. Participate in the Exhibit Hall Passport to Prizes game and enter to win prizes by visiting with the exhibitors. (See full details on page 20.) Stop by the SSO Membership Booth 616.

*This complimentary event is open to all registrants.
One drink ticket is located in your badge holder.
This event will have a cash bar.*

MEET THE PROFESSOR BREAKFASTS

6:45-7:45 am, Friday, March 23

*Separate Registration & Fee Required
Limit 30 per session. Breakfast is included.*

Considerations in Nipple-Sparing Mastectomy for Breast Cancer

James W. Jakub, MD
Mayo Clinic, Rochester, MN
Room E259

How to Get Published in a High-Impact Journal

Charles M. Balch, MD
University of Texas MD Anderson Cancer Center,
Houston, TX
Mark Roh, MD
Orlando Health UF Health Cancer Center, Orlando, FL
Deborah Whipple
Annals of Surgical Oncology
Room E260

Management of Borderline Resectable Pancreatic Cancer

Nipun B. Merchant, MD
University of Miami Medical Center, Miami, FL
Room E261

Management of IPMN

Peter J. Allen, MD
Memorial Sloan Kettering Cancer Center, New York, NY
Room E262

The Impact of Enhanced Recovery on Oncologic Outcomes

Thomas A. Aloia, MD
University of Texas MD Anderson Cancer Center,
Houston, TX
Room E263

The Use of Molecular Tests in Breast Cancer Surgery Planning

E. Shelley Hwang, MD, MPH
Duke University, Durham, NC
Room E264

Poster Contest Grand Rounds

7-7:55 am, Friday, March 23

Exhibit Hall D1 Foyer

Clinical Poster Award Nominees

7-7:25 am

Research Poster Award Nominees

7:30-7:55 am

PLENARY I

8-8:45 am, Friday, March 23

Room E354b

Moderators: Kelly M. McMasters, MD, PhD

Presenters:

Alessandro Gronchi, MD

*Fondazione IRCCS Istituto Nazionale dei Tumori,
Milan, Italy*

Naruhiko Ikoma, MD, MS

*University of Texas MD Anderson Cancer Center,
Houston, TX*

Campbell Roxburgh, PhD

Memorial Sloan Kettering Cancer Center, New York, NY

Jen Jen Yeh

University of North Carolina at Chapel Hill, Chapel Hill, NC

SSO MEMBERSHIP BOOTH 616

Stop by SSO Membership Booth 616 to relax in the lounge and meet colleagues. While at the booth, you may charge your phone, learn about the 25th Anniversary of *Annals of Surgical Oncology*, see a demo of ExpertEd@SSO, join or renew your membership, donate to the SSO Foundation or take a selfie at the Selfie Station.

THE CHARLES M. BALCH, MD, DISTINGUISHED SERVICE AWARD

8:45-8:55 am, Friday, March 23

Room E354b

Presented by: Jeffrey A. Drebin, MD, PhD

Honoring:

Norman Wolmark, MD

Professor and Chairman of Human Oncology
Drexel University School of Medicine, Philadelphia, PA

Bernard Fisher, MD

Distinguished Service Professor
University of Pittsburgh, Pittsburgh, PA

This Distinguished Service Award recognizes the work of Drs. Wolmark and Fisher with the National Surgical Adjuvant Breast and Bowel Project (NSABP).

Norman Wolmark, MD is Chairman of NSABP Foundation, a not-for-profit academic research organization with a 60-year history of conducting ground-breaking research studies in breast and colorectal cancer. He also serves as Chair and Principal Investigator of NCI-funded NRG Oncology. He is Professor and Chairman of Human Oncology at Drexel University School of Medicine. Dr. Wolmark received his medical degree from McGill University of Montreal, completed his residency at the University of Pittsburgh, and served a fellowship in Surgical Oncology at Memorial Sloan Kettering Cancer Center. He later became a cancer expert at the Surgery Branch of the National Cancer Institute. Dr. Wolmark's tenure as a cancer researcher and world-wide lecturer spans 45 years. He has published extensively, with more than 400 scientific journal articles and book chapters in print.



Bernard Fisher, MD's research has transformed current surgery, radiation therapy, and systemic adjuvant chemotherapy and hormonal therapy modalities for the treatment of breast and other cancers. As chairman of the National Surgical Adjuvant Breast and Bowel Project (NSABP) Dr. Fisher designed and conducted large-scale multi-institutional randomized clinical trials to test his hypothesis, based upon his laboratory research, that breast cancer is likely to be systemic at diagnosis. As a major consequence of two of his landmark trials, the prevailing paradigm governing the treatment of breast and other cancers for almost a century was supplanted by a new paradigm, and radical surgery began to be replaced by less-mutilating operations. Dr. Fisher and his colleagues were also the first to demonstrate that, when used as a preventive agent, tamoxifen significantly reduces breast cancer in women at high risk for the disease. Perhaps Dr. Fisher's most important contribution has been the establishment of the scientific approach to the understanding and treatment of breast cancer that has led to improvement in both survival rate and quality of life for women with the disease.



JAMES EWING LAYPERSON'S AWARD

8:55-9 am, Friday, March 23

Room E354b

Presented by: Kelly M. McMasters, MD, PhD

Honoring:

Alex Kimura, Sam Kimura, and Taylor Shorten

At age 17, **Sam Kimura** was diagnosed with severe aplastic anemia, a rare and deadly bone marrow failure disease, and was told she needed a bone marrow transplant to survive. Siblings are the most likely to be a match, but unfortunately, Sam's sister **Alex** was not a match. To make matters worse, neither were any of the 28 million people listed on the international donor registry. Sam's case is not unique: Over half of those fighting blood cancer and blood disorders cannot find their life-saving donor match.



For Sam Kimura, and the thousands of others searching for donors, Sam, Alex, and their best friend, **Taylor Shorten**, founded Sharing America's Marrow (SAM for short). SAM is a grassroots movement that finds regular people willing to become heroes by simply taking the time to swab their inner cheek and join the bone marrow donor registry to potentially donate to a patient in need.



In January 2015, The SAM team hit the road in their van named Maggie. Over the course of a year, they traveled to all 50 states to raise awareness and register donors. That year, SAM hosted 193 bone marrow donor registration events, signing up over 24,000 potential life-saving donors.

The road trip may be over, but the SAM movement is alive and well. To this day, Sam Kimura still needs a donor, so for her, and everyone else waiting for their hero to register, SAM keeps going.

Supported by an independent grant from The SSO Foundation.

SSO 2018 – 2020 STRATEGIC PLAN

*Advancing the Mission –
Increasing Engagement – Optimizing Resources*



Annual Meeting

▶ **GOAL:** Reimagine the SSO Annual Cancer Symposium



Membership

▶ **GOAL:** Develop a membership that is inclusive of all cancer surgeons



Global

▶ **GOAL:** Advance the awareness and impact of surgical oncology worldwide



Education

▶ **GOAL:** Support career-long education, recertification and quality patient care



Brand

▶ **GOAL:** Develop an inclusive brand image that articulates the mission and values of the Society



Organization Vitality

▶ **GOAL:** Responsible and flexible infrastructure

Learn more about the SSO Strategic Plan from SSO President, Kelly M. McMasters, MD, PhD during the SSO Town Hall Meeting on Saturday, March 24 at 5:00 pm.
See page 74 for details.

SSO PRESIDENTIAL ADDRESS

The Fundamental Difference Between Cancer Treatment and Patient Care

9-9:45 am, Friday, March 23

Room E354b

Introduction by: Armando E. Giuliano, MD

Kelly M. McMasters, MD, PhD

Ben A. Reid, Sr., MD Professor and Chair
The Hiram C. Polk Jr., MD Department
of Surgery

*University of Louisville School of
Medicine, Louisville, KY*



Dr. McMasters is the Ben A. Reid, Sr. Professor and Chair of the Hiram C. Polk, Jr., MD Department of Surgery, University of Louisville School of Medicine, and Director of the Multidisciplinary Melanoma Clinic, James Graham Brown Cancer Center, Louisville, Kentucky. He earned his MD at the University of Medicine and Dentistry of New Jersey Robert Wood Johnson Medical School and his PhD in Cell and Developmental Biology from Rutgers University. He completed his Fellowship in Surgical Oncology at the University of Texas-MD Anderson Cancer Center in Houston. He is the author and Principal Investigator of the Sunbelt Melanoma Trial, a multi-institutional study involving 3500 patients from 79 institutions across North America. His research has been funded by the American Cancer Society, the National Institutes of Health, and the Melanoma Research Foundation, among other agencies. He has two patents for his research inventions. Dr. McMasters is currently President of the Society of Surgical Oncology and the Western Surgical Association, Secretary of the Southern Surgical Association (2014-2019), and Vice President of the Society of Surgical Chairs. He was a member of the Melanoma Staging Committee of the American Joint Commission on Cancer and is former President of the Southeastern Surgical Congress (2009-2010). He has authored more than 400 publications and is Editor of the book Hepatocellular Carcinoma: Targeted Therapy and Multidisciplinary Care.

Refreshment Break in Exhibit Hall

9:45-10:15 am, Friday, March 23

View Exhibits & Posters

Exhibit Hall D1

FRIDAY

VIDEO SESSION

Friday Exhibit Hall Videos Friday

9:50-10:10 am, Friday, March 23

Exhibit Hall Theater, Exhibit Hall D1

Moderators: Ajay V. Maker, MD and
Alexander Parikh, MD, MPH

Anthony Aurelio Castelli, MD

*Advocate Illinois Masonic Medical Center, University of
Illinois - Chicago Metropolitan Group Hospitals, Chicago, IL*

Jianping Gong

*Tongji Hospital, Tongji Medical College, Huazhong
University of Science and Technology, Wuhan, Hubei, China*

SYMPOSIUM

Current Management of Nodal Metastases in Patients with Melanoma (MOC)

10:15 am-12:15 pm, Friday, March 23

Room E350

Moderators: Michael C. Lowe, MD, MA and
Jonathan S. Zager, MD

Faculty:

Daniel G. Coit, MD

Memorial Sloan Kettering Cancer Center, New York, NY

Mark B. Faries, MD

The Angeles Clinic/Cedars Sinai, Los Angeles, CA

Jason J. Luke, MD

University of Chicago Medicine, Chicago, IL

Merrick I. Ross, MD

*University of Texas MD Anderson Cancer Center,
Houston, TX*

John Thompson, MD

*The University of Sydney, Melanoma Institute of Australia,
Sydney, New South Wales, Australia*

PARALLEL SESSION

Breast Parallel Session 2

10:15 am-12:15 pm, Friday, March 23

Room E450a

Moderators: Carla S. Fisher, MD and
Julie A. Margenthaler, MD

Presenters:

Alison Unzeitig Barron, MD

Mayo Clinic, Rochester, MN

Amulya Alapati, MD

Beth Israel Deaconess Medical Center, Boston, MA

Francesca Delach, MD

Bryn Mawr Hospital, Wyncote, PA

Kerry-Ann McDonald, MD

Roswell Park Cancer Institute, Buffalo, NY

Tracy-Ann Moo

Memorial Sloan Kettering Cancer Center, New York, NY

Ingrid Poodt, MD

Catharina Hospital Eindhoven, Rotterdam, Netherlands

NOT
FOR
CREDIT

Nina Tamirisa, MD

Duke University Medical Center, Galveston, TX

Walter Paul Weber, MD

University Hospital Basel, Basel, CH, Switzerland

Jennifer Michelle Wellington, MD

*Walter Reed National Military Medical Center,
Arlington, VA*

Min Yi

UT MD Anderson Cancer Center, Houston, TX

PARALLEL SESSION

Hepato-pancreato-biliary Parallel Session 2

10:15 am-12:15 pm, Friday, March 23

Room E450b

Moderators: Kimberly M. Brown, MD and Perry Shen, MD

Presenters:

Irmna A. Elliott

UCLA, Los Angeles, CA

Alexander Fisher

University of Wisconsin, Madison, WI

Johan Gagniere, MD, PhD

Memorial Sloan Kettering Cancer Center, New York, NY

Matthew Hernandez, MD

Mayo Clinic, Rochester, MN

Amanda Kirane

UC Davis, Sacramento, CA

James Michael Lindberg

*The University of Texas MD Anderson Cancer Center,
Houston, TX*

Harshul Pandit, MS

University of Louisville, Louisville, KY

Roheena Z. Panni, MD

Washington University in Saint Louis, Saint Louis, MO

Benjamin Schmidt, MD

University of North Carolina, Chapel Hill, NC

Natalie Seiser, MD, PhD

UPMC, Pittsburgh, PA

2018 HARVEY BAKER TRAVELING FELLOW AWARD

The Society congratulates Roheena Z. Panni, MD, who is attending SSO 2018 as the recipient of the 2018 Harvey Baker Traveling Fellow Award for the following abstract to be presented in this session: **57: Reprogramming Tumor Microenvironment to Improve Responses to Immunotherapy in Pancreatic Cancer.** See the SSO Events mobile app for full SSO 2018 presenter and abstract information. Supported by an independent grant from The SSO Foundation.

SYMPOSIUM

Adaptation of New Technology for Rectal Cancer: Do I Need New Tools in My Toolbox? (MOC)

10:15 am-12:15 pm, Friday, March 23

Room E451b

Moderators: Glen C. Balch, MD, MBA and
George J. Chang, MD, MS

Faculty:

Peter W. Marcello, MD

Lahey Hospital and Medical Center, Burlington, MA

Jeffrey W. Milsom, MD

Weill Cornell Medicine, New York, NY

Philip B. Paty, MD

Memorial Sloan Kettering Cancer Center, New York, NY

Alessio Pigazzi, MD, PhD

UC Irvine Health, School of Medicine, Orange, CA

Karyn B. Stitzenberg, MD, MPH

University of North Carolina, Chapel Hill, NC

Patricia Sylla, MD

Mount Sinai Hospital, New York, NY

Exhibit Hall Lunch

(See page 21 for details.)

12:15-1:15 pm, Friday, March 23

View Exhibits & Posters

Exhibit Hall D1

Poster Grand Rounds

12:30-1 pm

ePoster Monitors, Exhibit Hall D1

- Colorectal - ePoster Station 1
- Melanoma - ePoster Station 2
- Sarcoma - ePoster Station 3
- Upper Gastrointestinal - ePoster Station 4

SELFIE STATION

Capture a photo with your colleagues at SSO's Selfie Stations. Station A is located in the Registration Foyer and Station B is located at SSO Membership Booth 616. Be sure to post your photo on Twitter and use **#SSO2018**.

PLENARY II

1:15-2 pm, Friday, March 23

Room E354b

Moderators: Armando E. Giuliano, MD

Presenters:

Joel Baumgartner

University of California San Diego, La Jolla, CA

Danielle M. Bello, MD

Memorial Sloan Kettering Cancer Center, New York, NY

Mashaal Dhir, MD

SUNY Upstate Medical University, Syracuse, NY

Julie E. Lang, MD

University of Southern California, Los Angeles, CA

THE GREAT DEBATES I

2-3:15 pm, Friday, March 23

Room E354b

Moderators: Felipe JF Coimbra, MD, and
Charles R. Scoggins, MD, MBA

**Neoadjuvant Chemotherapy for Resectable Extremity
Soft Tissue Sarcomas is Ready for Primetime**

Pro: Frederick C. Eilber, MD

UCLA, Los Angeles, CA

Con: Chandrajit P. Raut, MD, MSc

*Brigham and Women's Hospital/Dana-Farber Cancer
Institute, Boston, MA*

**Genetic Mutation Analysis Should be Included in
Decision Making of Liver-Directed Therapy for
Colorectal Liver Metastases**

Pro: Yun Shin Chun, MD

*University of Texas MD Anderson Cancer Center,
Houston, TX*

Con: Michael I. D'Angelica, MD

Memorial Sloan Kettering Cancer Center, New York, NY

QUICK SHOT SESSION

Melanoma Quick Shot Abstracts

2:15-3:15 pm, Friday, March 23

Room E350

Moderators: Charlotte E. Ariyan, MD, PhD and
Paul J. Mosca, MD, PhD, MBA

Presenters:

Janice Austin, MD

University of Toronto, Toronto, ON, Canada

Sarah Banting

Peter MacCallum Cancer Centre, Melbourne, VIC, Australia

Emmanuel Gabriel, MD, PhD

Mayo Clinic Florida, Jacksonville, FL

Kim Elizabeth Isaacs, MBBS

Melanoma Institute of Australia, Bronte, NSW, Australia

Jennifer Keller, MD

Saint Louis University School of Medicine, Saint Louis, MO

Stanley P. Leong, MD

California Pacific Medical Center, San Francisco, CA

Fionnuala Mary O'Leary, MD

Norfolk And Norwich Hospital, Norwich, United Kingdom

Matthew Perez

Moffitt Cancer Center, Tampa, FL

Darryl Schuitevoerder

Oregon Health & Science University, Portland, OR

Iman A. Soliman

Fox Chase Cancer Center, Philadelphia, PA

QUICK SHOT SESSION

Breast Quick Shot Abstracts

2:15-3:15 pm, Friday, March 23

Room E450a

Moderators: Nora M. Hansen, MD and
Dhairyasheel Savant, MS, FICS

Presenters:

Juan Camilo Barreto-Andrade, MD

University of Arkansas for Medical Sciences, Little Rock, AR

Peter A. Barry, MBBS, MPhil

Royal Marsden Hospital, Sutton, London, United Kingdom

Isabelle Bedrosian, MD

MD Anderson Cancer Center, Houston, TX

Neal Bhutiani, MD

University of Louisville, Louisville, KY

Oluwadamilola Motunrayo Fayanju, MD, MA, MPHS

Duke University, Durham, NC

Jessica C. Gooch, MD

NYU Langone Health, New York, NY

Eriko Katsuta

Roswell Park Cancer Institute, Buffalo, NY

Amelia Younker Merrill, MD, MPH

Wake Forest School of Medicine, Winston-Salem, NC

Kazuaki Takabe

Roswell Park Cancer Institute, Buffalo, NY

Julia van Steenhoven

Diakonessenhuis Utrecht, Amsterdam, Netherlands

QUICK SHOT SESSION

**Quality Improvement/Clinical Outcomes
Quick Shot Abstracts**

2:15-3:15 pm, Friday, March 23

Room E450b

Moderators: Ned Z. Carp, MD and Sharon M. Weber, MD

Lev David Bubis, MD

University of Toronto, Toronto, ON, Canada

Catherine Hambleton Davis, MD

*University of Texas MD Anderson Cancer Center,
Houston, TX*

Eleanor A. Fallon, MD

Brown University/Rhode Island Hospital, Providence, RI

Adam Khader, MD

Hofstra Northwell School of Medicine, Manhasset, NY

Helmi Khadra, MD

Tulane University School of Medicine, New Orleans, LA

Christopher James LaRocca

City of Hope National Medical Center, Duarte, CA

Jennifer Olson

University of California, Davis, Sacramento, CA

Mustafa Raoof, MD, MS

City of Hope Cancer Center, Duarte, CA

Patrick R. Varley, MD

UPMC, Pittsburgh, PA

G. Paul Wright, MD

*Spectrum Health/Michigan State University CHM,
Grand Rapids, MI*

QUICK SHOT SESSION
Colorectal Quick Shot Abstracts
2:15-3:15 pm, Friday, March 23
Room E451b

Moderators: Jorge S. Lyra, MD and Iris H. Wei, MD

Nelleke Pietronella Maria Brouwer, BSc

*Radboud University Medical Center,
Nijmegen, Gelderland, Netherlands*

Ahmed Dehal, MD, MPH

John Wayne Cancer Institute, Santa Monica, CA

Josephine Hendrikson, BS

National Cancer Centre Singapore, Singapore

Byron D. Hughes, MD, MPH

University of Texas Medical Branch, Galveston, TX

Tsuyoshi Konishi, MD, PhD

*Cancer Institute Hospital of the Japanese Foundation for
Cancer Research, Tokyo, Japan*

Ioannis Konstantinidis

City of Hope Cancer Center, Duarte, CA

Bradley Aaron Krasnick, MD

Washington University in St. Louis, St. Louis, MO

Sumana Narayanan

Roswell Park Cancer Institute, Buffalo, NY

Matthew Symer, MD

Weill Cornell Medical College, New York, NY

Lai Xue, MD

University of Chicago, Chicago, IL

Ice Cream Break in Exhibit Hall
3:15-4 pm, Friday, March 23
View Exhibits & Posters
Exhibit Hall D1

SSO MEMBERSHIP BOOTH 616

Stop by SSO Membership Booth 616 to relax in the lounge and meet colleagues. While at the booth, you may charge your phone, learn about the 25th Anniversary of *Annals of Surgical Oncology*, see a demo of ExpertEd@SSO, join or renew your membership, donate to the SSO Foundation or take a selfie at the Selfie Station.

PARALLEL SESSION

Melanoma Parallel Session

4-6 pm, Friday, March 23

Room E350

Moderators: Mary S. Brady, MD and
Jeffrey D. Wayne, MD

Edmund Bartlett, MD

Memorial Sloan Kettering Cancer Center, New York, NY

Eric A. Deckers

UMCG, Groningen, Netherlands

Jennifer Erdrich

Cedars Sinai Medical Center, Los Angeles, CA

Ravinder Kang, MD, MS

Dartmouth-Hitchcock Medical Center, Lebanon, NH

Jay Soong-Jin Lee, MD

*University of Michigan Comprehensive Cancer Center,
Ann Arbor, MI*

Michelle Lo, MBChB, BSc, MRCS

*Norfolk & Norwich University Hospital, Norwich, United
Kingdom*

Amanda A.G. Nijhuis, BS

*Melanoma Institute Australia, Velden, Limburg,
Netherlands*

Andrew John Sinnamon, MD

*Hospital of the University of Pennsylvania,
Philadelphia, PA*

Henry G. Smith, MRCS

*The Royal Marsden Hospital, Ashford, Kent,
United Kingdom*

Danielle Verver, MD

Erasmus MC Cancer Institute, Utrecht, Netherlands

ExpertEd@SSO – YOUR POST-CONFERENCE RESOURCE

ExpertEd@SSO is your post-conference destination to supplement your education with a variety of programs developed by preeminent surgical oncology thought leaders. Use ExpertEd@SSO to claim CME and MOC from attendance at sessions. Visit surgonc.org/ExpertEd.



SYMPOSIUM

Immunotherapy and Breast Cancer (MOC)

4-6 pm, Friday, March 23

Room E450a

Moderators: Barbara A. Pockaj, MD and
Richard L. White, Jr.

Faculty:

Karen S. Anderson, MD, PhD

Biodesign Institute, Tempe, AZ

Brian J. Czerniecki, MD, PhD

H. Lee Moffitt Cancer Center, Tampa, FL

Elizabeth A. Mittendorf, MD, PhD

*University of Texas MD Anderson Cancer Center,
Houston, TX*

Rita Nanda, MD

University of Chicago Medicine, Chicago, IL

George Plitas, MD

Memorial Sloan Kettering Cancer Center, New York, NY

Barbara A. Pockaj, MD

Mayo Clinic, Phoenix, AZ

Austin D. Williams, MD, MEd

University of Pennsylvania, Philadelphia, PA

SYMPOSIUM

Clinical Trials for Surgeons: Hurdles and Opportunities

4-6 pm, Friday, March 23

Room E450b

Moderators: Thomas A. Aloia, MD, and
Julie Ann Sosa, MD, MA

Faculty:

Darren R. Carpizo, MD, PhD

*Rutgers Cancer Institute of New Jersey; Rutgers
Robert Wood-Johnson University Medical School,
New Brunswick, NJ*

Kelly K. Hunt, MD

*University of Texas MD Anderson Cancer Center,
Houston, TX*

Matthew H.G. Katz, MD

*University of Texas MD Anderson Cancer Center,
Houston, TX*

Eleftherios P. Mamounas, MD

Orlando Health UF Health Cancer Center, Orlando, FL

Gary W. Unzeitig, MD

Laredo Breast Care, Laredo, TX

Y. Nancy You, MD, MHSc

*University of Texas MD Anderson Cancer Center,
Houston, TX*

PARALLEL SESSION

Colorectal Parallel Session

4-6 pm, Friday, March 23

Room E451b

Moderators: Jason Park, MD, MEd and
J. Joshua Smith, MD, PhD

Blake DeWayne Babcock, MD

Loma Linda University Medical Center, Loma Linda, CA

Darren Bryan, MD

University of Chicago, Chicago, IL

George J. Chang, MD, MS

*University of Texas MD Anderson Cancer Center,
Houston, TX*

Mohammad Raheel Jajja, MD

Winship Cancer Institute, Emory University, Atlanta, GA

Patrick D. Lorimer, MD

*Levine Cancer Institute, Carolinas HealthCare System,
Charlotte, NC*

Andre B. Martel, MD

University of Ottawa, Ottawa, ON, Canada

Sumana Narayanan

Roswell Park Cancer Institute, Buffalo, NY

Elizabeth Carla Poli, MD

University of Chicago, Chicago, IL

Wijntje Johanneke van Eden, MD

*The Netherlands Cancer Institute, Amsterdam,
Netherlands*

Benjamin Weixler

*Charite University Hospital Berlin, Campus Benjamin
Franklin, Berlin, Germany*

PRESIDENT'S RECEPTION

6-7:30 pm, Saturday, March 24

(Ticket required)

Regency Ballroom, Hyatt Regency McCormick Place

SSO President Dr. Kelly McMasters invites you to join him Saturday evening for cocktails and hors d'oeuvres. This event will provide an excellent opportunity for you to connect with friends and colleagues to discuss news from the meeting and make plans to reconnect next year in San Diego.

MEET THE PROFESSOR BREAKFASTS

6:45-7:45 am, Saturday, March 24

*Separate Registration & Fee Required
Limit 30 per session. Breakfast is included.*

How the MSLT Trials Impact My Melanoma Practice

Mark B. Faries, MD

The Angeles Clinic/Cedars Sinai, Los Angeles, CA

Room E259

HIPEC: Why and How?

Edward A. Levine, MD

Wake Forest University, Winston-Salem, NC

Room E260

Gastric and GE Junction Cancer: Optimal Multidisciplinary Management

Michell C. Posner, MD

University of Chicago Medicine, Chicago, IL

Room E261

Management of Locally Recurrent Rectal Cancer

George J. Chang, MD, MS

*University of Texas MD Anderson Cancer Center,
Houston, TX*

Room E262

Management of Primary and Recurrent RPS

Carol J. Swallow, MD, PhD

University of Toronto, Toronto, ON, Canada

Room E263

Non-Operative Management of Rectal Cancer.

Martin R. Weiser, MD

Memorial Sloan Kettering Cancer Center, New York, NY

Room E264

SSO 2018 Virtual Meeting

Miss a session during SSO 2018? Wondering how you can still get access to the cutting-edge material presented at the meeting? As a registered conference attendee, you will be able to access SSO 2018 recordings at no additional charge.

*To access the SSO 2018 Virtual Meeting,
visit **surgonc.org/ExpertEd**.*

PARALLEL SESSION

Disparities Parallel Session

8-9:30 am, Saturday, March 24

Room E350

Moderators: Elizabeth A. Marcus, MD and
Monica Rizzo, MD

Presenters:

John C. Hardaway, MD, PhD

Roger Williams Cancer Center, Providence, RI

Laura Kruper, MD

City of Hope, Los Angeles, CA

Brendan P. Lovasik, MD

Emory University, Atlanta, GA

Ilya Rakitin, MD

Henry Ford Health System, West Bloomfield, MI

Samer Tohme, MD

University of Pittsburgh Medical Center, Pittsburgh, PA

Abhineet Uppal, MD

University of Chicago, Chicago, IL

Brooke Vuong, MD

*John Wayne Cancer Institute at Providence Saint John's
Health Center, Los Angeles, CA*

Siun Walsh

Memorial Sloan Kettering Cancer Center, New York, NY

SYMPOSIUM

Local and Regional Therapy Options for Primary and Metastatic Tumors in Hepatobiliary Surgery (MOC)

8-9:30 am, Saturday, March 24

Room E450a

Moderators: Motaz Qadan, MD, PhD, and
T. Clark Gamblin, MD, MS, MBA

Faculty:

Carlos Fernández-del Castillo, MD

Massachusetts General Hospital, Boston, MA

T. Peter Kingham, MD

Memorial Sloan Kettering Cancer Center, New York, NY

Robert C.G. Martin, II, MD, PhD

University of Louisville School of Medicine, Louisville, KY

Jonathan S. Zager, MD

H. Lee Moffitt Cancer Center, Tampa, FL

SYMPOSIUM

My Patient Read the Internet: Molecular Markers and Novel Treatments for Colorectal Cancer (MOC)

8-9:30 am, Saturday, March 24

Room E450b

Moderators: James R. Howe, MD, and
Martin R. Weiser, MD

Faculty:

Rebecca C. Auer, MD, MSc

*University of Ottawa, Ottawa Hospital Research Institute,
Ottawa, ON, Canada*

Blasé N. Polite, MD, MPP

University of Chicago Medicine, Chicago, IL

David Shibata, MD

*University of Tennessee Health Science Center,
Memphis, TN*

Y. Nancy You, MD, MHSc

*University of Texas MD Anderson Cancer Center,
Houston, TX*

SYMPOSIUM

Subtype-Specific Biology and Treatment of Soft Tissue Sarcomas (MOC)

8-9:30 am, Saturday, March 24

Room E451b

Moderators: Giorgos C. Karakousis, MD, and
Sam S. Yoon, MD

Faculty:

Robert J. Canter, MD

UC Davis Comprehensive Cancer Center, Sacramento, CA

Aimee M. Crago, MD, PhD

Memorial Sloan Kettering Cancer Center, New York, NY

Rebecca Gladdy, MD, PhD

Mount Sinai Hospital, Toronto, ON, Canada

Samuel Singer, MD

Memorial Sloan Kettering Cancer Center, New York, NY

Refreshment Break

9:30-9:45 am, Saturday, March 24

Exhibit Hall D1 Foyer

AMERICAN CANCER SOCIETY/ SSO BASIC SCIENCE LECTURE

**Mixing It Up: Rewiring the Transcriptome of
Pancreatic Cancer Cells and Surgeon Scientists**

9:45-10:30 am, Saturday, March 24

Room E450b

Steven D. Leach, MD

Director, Norris Cotton Cancer Center
Dartmouth Geisel School of Medicine

Preston T. and Virginia R. Kelsey
Distinguished Chair in Cancer

Professor of Molecular and Systems
Biology

Dartmouth-Hitchcock Health System
Hanover, NH



Dr. Leach is Professor of Molecular and Systems Biology, the Preston T. and Virginia R. Kelsey Distinguished Chair in Cancer, and Director of the Norris Cotton Cancer Center at the Dartmouth Geisel School of Medicine and Dartmouth-Hitchcock Medical Center. Dr. Leach received his bachelor's degree with high honors in Biology from Princeton University. He then completed medical school at Emory University, where he was a Robert Woodruff Fellow, followed by additional clinical and scientific training at Yale and M.D. Anderson. Prior to moving to Dartmouth in 2017, Dr. Leach held faculty positions at Vanderbilt, Johns Hopkins and Memorial Sloan Kettering. Dr. Leach's lab has a long track record of groundbreaking discoveries, including the identification of several genes and pathways that are now being targeted in clinical trials for pancreatic cancer patients. He has been the principal investigator for multiple NIH R01, P01 and T32 grants, and has received multiple awards honoring his work. In addition to his research activities, Dr. Leach has also served as Chair of the Pancreatic Cancer Action Network's Scientific and Medical Advisory Board, as co-Editor-in-Chief of *Current Opinion in Genetics and Development*, and as a member of the Princeton University Board of Trustees.

Supported by an independent educational grant from the American Cancer Society.

CLINICAL AND YOUNG INVESTIGATOR AWARD PRESENTATIONS

10:30-11:05 am, Saturday, March 24

Room E450b

Moderator: Darren R. Carpizo, MD, PhD

The CIA, established in 2007 by the SSO, helps to promote post-fellowship, patient-oriented research through the training of surgical oncologists in clinical and translational science. Each Award consists of \$100,000, disbursed in two yearly installments of \$50,000. To date, 30 Clinical Investigator Awards totaling more than \$3 million dollars have been granted to researchers. Beginning with the 2013-2015 awards cycle, the administration and management of the CIA and YIA program was moved to The SSO Foundation.

The SSO Foundation Young Investigator Award in Surgical Oncology was established from the 75 for 75 Campaign funds to promote and recognize clinical/translational research that advances innovative ideas and concepts designed to improve health outcomes through advances in the delivery of cancer-related care. One \$25,000 award will be given at the conclusion of the CIA session. This year's YIA called for melanoma-related research projects, in honor of Dr. Donald L Morton, a pioneer in melanoma research. The Morton Fund, a restricted fund comprised of individual donations given in Dr. Morton's memory, is providing a portion of the funding for this year's award.

Supported by independent grants from Amgen, Genentech and The SSO Foundation.

Presenters:

Robert J. Canter, MD

*UC Davis Comprehensive Cancer Center,
Sacramento, CA*

Kelly Olino, MD

*University of Texas Medical Branch of Galveston,
Galveston, TX*

Vikas Dudeja, MD

University of Miami, Miami, FL

Announcement of the 2018 Clinical & Young Investigator Award Recipients

Monica Morrow, MD

THE GREAT DEBATES II

11:05 am-12:30 pm, Saturday, March 24

Room E450b

Moderators: Ricardo A. Audisio, MD, PhD(Hon), and Heather L. Yeo, MD, MHS

Non-Operative Management of Rectal Cancer is Ready for Primetime

Pro: Julio Garcia-Aguilar, MD, PhD

Memorial Sloan Kettering Cancer Center, New York, NY

Con: George J. Chang, MD, MS

University of Texas MD Anderson Cancer Center, Houston, TX

Surgeons Should Be Credentialed Based on Video Review

Pro: Justin B. Dimick, MD, MPH

University of Michigan, Ann Arbor, MI

Con: Herbert J. Zeh, III, MD

University of Pittsburgh Medical Center, Pittsburgh, PA

QUICK SHOT SESSION

HPB/Upper GI Quick Shot Abstracts

11:15 am-12:15 pm, Saturday, March 24

Room E450a

Moderators: Carl R. Schmidt, MD and Frances R. Spitz, MD

Neal Bhutiani, MD

University of Louisville, Louisville, KY

Darren R. Carpizo, MD, PhD

Rutgers Cancer Institute of New Jersey, New Brunswick, NJ

Vikrom Kumar Dhar, MD

University of Cincinnati, Cincinnati, OH

Yael Feferman, MD

Rabin Medical Center, Affiliated with Sackler Faculty of Medicine, Tel Aviv University, Tel Aviv, Israel

Andrew Lee, MD, PhD

MD Anderson Cancer Center, Houston, TX

Daniel Philip Nussbaum, MD

Duke University, Durham, NC

Jill Carol Rubinstein

Yale School of Medicine, New Haven, CT

Ashley E. Russo, MD

Memorial Sloan Kettering Cancer Center, New York, NY

Christine Velazquez

Wake Forest Baptist Health, Winston Salem, NC

Elaine Vo, MD

Baylor College of Medicine, Houston, TX

QUICK SHOT SESSION

Sarcoma Quick Shot Abstracts

11:15 am-12:15 pm, Saturday, March 24
Room E451b

Moderators: John T. Mullen, MD and
Carolyn Nessim, MD, MSc

Marco Fiore, MD

*Fondazione IRCCS Istituto Nazionale dei Tumori,
Milan, Italy*

Sarah B. Fisher, MD

MD Anderson Cancer Center, Houston, TX

Amanda N. Goldin, MD

University of California San Diego, San Diego, CA

Aileen C. Johnson, BS

Winship Cancer Institute, Emory University, Atlanta, GA

Eleftherios A. Makris, MD, PhD

Stanford University, Redwood City, CA

Marc G. Stevenson, MD

*University of Groningen, University Medical Center
Groningen, Groningen, Netherlands*

Lorena P. Suarez-Kelly

The Ohio State University, Columbus, OH

Cornelius A. Thiels, DO, MBA

Mayo Clinic, Rochester, MN

Kara Vande Walle, MD

University of Wisconsin, Madison, WI

Lunch on Own

12:30-1:30 pm, Saturday, March 24

Surgical Clinical Trials Investigator Meeting

12:30-1:30 pm, Saturday, March 24
Rooms E253a and E253b

SSO 2018 Virtual Meeting

Miss a session during SSO 2018? Wondering how you can still get access to the cutting-edge material presented at the meeting? As a registered conference attendee, you will be able to access SSO 2018 recordings at no additional charge.

*To access the SSO 2018 Virtual Meeting,
visit surgonc.org/ExpertEd.*

PARALLEL SESSION

Upper Gastrointestinal Parallel Session

1:30-3 pm, Saturday, March 24

Room E450a

Moderators: Do Joong Park, MD, PhD and
Adam Yopp, MD

Katherine D. Gray, MD

New York Presbyterian-Cornell, New York, NY

Teresa Kim, MD

University of Washington, Seattle, WA

Guy Lahat

Tel Aviv Sourasky Medical Center, Tel Aviv, Israel

Natasha L. Leigh, MD

Icahn School of Medicine Mt. Sinai, New York, NY

Miranda Lin

Stony Brook Medical Center, Nesconset, NY

Diego Vicente, MD

*University of Texas MD Anderson Cancer Center,
Houston, TX*

Urs von Holzen

Goshen Center for Cancer Care, Goshen, IN

VIDEO SESSION

Top Rated Videos

1:30-3 pm, Saturday, March 24

Room E450b

Moderators: Brian J. Kaplan, MD and
Danny Yakoub, MD, PhD

Essa M. Aleassa, MD

Cleveland Clinic Foundation, Cleveland, OH

Maha Alkhuziem

University of California San Diego, La Jolla, CA

Kerianne Boulva

University of Montreal, Montreal, QC, Canada

Ea-sle Chang

Saint Louis University, Saint Louis, MO

Stephen R. Grobmyer, MD

Cleveland Clinic, Cleveland, OH

Julie L. Hallet

Sunnybrook Health Sciences Centre, Toronto, ON, Canada

Aaron Saunders, MD

Roswell Park Cancer Institute, Loma Linda, CA

Yalini Vigneswaran

University of Chicago Medicine, Chicago, IL

PARALLEL SESSION

Sarcoma Parallel Session

1:30-3 pm, Saturday, March 24

Room E451b

Moderators: Sanjay P. Bagaria, MD and
Dan (Trey) Blazer, MD

Presenters:

Mark Fairweather

Brigham and Women's Hospital, Boston, MA

Eva Aleida Huis in 't Veld, MD

*Royal Marsden Hospital, Amsterdam, Noord-Holland,
Netherlands*

George Li, MD

Memorial Sloan Kettering Cancer Center, New York, NY

Deanna Ng

National Cancer Centre, Singapore

Henry G. Smith, MRCS

*The Royal Marsden Hospital, Ashford, Kent, United
Kingdom*

Zachary E. Stiles, DO

*University of Tennessee Health Science Center,
Memphis, TN*

Lorena P. Suarez-Kelly

The Ohio State University, Columbus, OH

Jennifer Tseng, MD

University of Chicago Medicine, Chicago, IL

Refreshment Break

3-3:15 pm, Saturday, March 24

Exhibit Hall D1 Foyer

SYMPOSIUM

Surgical Cytoreduction and Regional Chemotherapy: State of the Science

3:15-4:45 pm, Saturday, March 24

Room E450a

Moderators: H. Richard Alexander, Jr., MD and
Edward A. Levine, MD

Faculty:

Brian D. Badgwell, MD, MS

*University of Texas MD Anderson Cancer Center,
Houston, TX*

Charles A. Staley, MD

Emory University School of Medicine, Atlanta, GA

Kiran K. Turaga, MD, MPH

University of Chicago, Chicago, IL

SYMPOSIUM

Lifting the Veil: The Surgeon's Role in Quality Initiatives in Surgical Oncology

3:15-4:45 pm, Saturday, March 24

Room E450b

Moderators: Fabian M. Johnston, MD, MHS, and
Larissa Temple, MD

Faculty:

Jin He, MD, PhD

Johns Hopkins Medicine, Baltimore, MD

Samantha Hendren, MD, MPH

University of Michigan, Ann Arbor, MI

Sushanth Reddy, MD

University of Alabama at Birmingham, Birmingham, AL

David P. Winchester, Sr., MD

American College of Surgeons, Chicago, IL

SYMPOSIUM

International Cancer Consortia: Where Do We Stand?

3:15-4:45 pm, Saturday, March 24

Room E451b

Moderators: Fergal J. Fleming, MD, and
Robin S. McLeod, MD, BSc

Faculty:

Erin D. Kennedy, MD, PhD

Mount Sinai Hospital, Toronto, ON, Canada

John R.T. Monson, MD

Florida Hospital Orlando, Orlando, FL

Hideki Ueno, MD, PhD

National Defense Medical College, Saitama, Japan

Jürgen Weitz, MD, MSc

University Hospital Carl Gustav Carus of the Technical University Dresden, Dresden, Saxony, Germany

Break

4:45-5 pm, Saturday, March 24

PRESIDENT'S RECEPTION

6-7:30 pm, Saturday, March 24

(Ticket required)

Regency Ballroom, Hyatt Regency McCormick Place

SSO President Dr. Kelly McMasters invites you to join him Saturday evening for cocktails and hors d'oeuvres. This event will provide an excellent opportunity for you to connect with friends and colleagues to discuss news from the meeting and make plans to reconnect next year in San Diego.

TOWN HALL & ANNUAL SSO BUSINESS MEETING

5-5:30 pm, Saturday, March 24
Room E350

Annual SSO Business Meeting Agenda

- I. **Call to Order**
Kelly M. McMasters, MD, PhD, Presiding
- II. **Announcement of Annual Resident/Fellow Essay Award Winners**
- III. **President's Report**
 - Recognition of Program Chair
 - SSO 2018-2020 Strategic Plan
- IV. **Secretary's Report**
Douglas S. Tyler, MD
 - In Memoriam
 - Introduction of New Members
- V. **Treasurer's Report**
Sandra Wong, MD
- VI. **The SSO Foundation Report**
Monica Morrow, MD
- VII. ***Annals of Surgical Oncology* Report**
Charles M. Balch, MD
- VIII. **Membership Open Forum**
Kelly M. McMasters, MD, PhD
Armando E. Giuliano, MD
- IX. **Award Recipients Announced**
Kelly M. McMasters, MD, PhD
- X. **Recognition of Outgoing Councilors**
Kelly M. McMasters, MD, PhD
- XI. **Nominating Committee Report**
Ronald J. Weigel, MD, PhD
- XII. **Introduction of New President**
Kelly M. McMasters, MD, PhD
- XIII. **New Business**
Armando E. Giuliano, MD
 - SSO 2019, March 27-30, San Diego, CA
- XIV. **Adjourn**

GLOBAL PARTNER POSTERS

As a result of SSO's partnership with various international societies and a successful launch in 2016, SSO 2018 will feature the Global Partner Posters section in the hall, where top abstracts from six worldwide events over the past year will be highlighted. These posters are located in the front section of posters in **Exhibit Hall D1** with separate signage.

NOT
FOR
CREDIT

See page 79 for full poster information and hours.

Highlighted Posters From the Brazilian Society of Surgical Oncology

- GP1** **Epstein-Barr Virus, Microsatellite Instability and PD-L1 Expression in Gastric Adenocarcinoma: Clinicopathological and Prognostic Aspects**
Marcus Fernando Kodama Pertille Ramos, MD
University of São Paulo Medical School, São Paulo, São Paulo, Brazil
- GP2** **Interval and In Transit Sentinel Node Drainage as a Predictor Factor in Melanoma Patients**
Eduardo Bertolli, MD, MSc
AC Camargo Cancer Center, São Paulo, São Paulo, Brazil
- GP3** **Neutrophil-lymphocyte Ratio is Associated with Prognosis in Patients who Underwent Potentially Curative Resection for Gastric Cancer**
Daniel José Szor, MD
Faculdade de Medicina da Universidade de São Paulo (FMUSP), São Paulo, São Paulo, Brazil

Highlighted Posters from the Chinese Society of Clinical Oncology

- GP4** **An Intra-Operative RT-LAMP Method Allows Rapid and Reliable Detection of Sentinel Lymph Node Metastasis in Breast Cancer Patients**
Xiaopeng Hao, MD
PLA 307 Hospital, Beijing, P.R., China

Highlighted Posters from the Canadian Society of Surgical Oncology

- GP5** **Long-term Outcomes of Resection for Locoregionally Recurrent Colon Cancer: A Multi-centered Retrospective Descriptive Cohort Study**
Tyler R. Chesney, MD, MSc
University of Toronto, Toronto, ON, Canada

GP6 Colorectal Cancer Treatment and Outcomes for Patients with a Severe Psychiatric Illness: Evidence for Inequalities in a Universal Health Care System

Natalie Coburn, MD, MPH

Sunnybrook Health Sciences Centre, Toronto, ON, Canada

GP7 Radioactive Seed Localization versus Wire-Guided Localization for Non-palpable Breast Cancer: A Cost and OR Efficiency Analysis

Carolyn Nessim, MD, MSc

University of Ottawa, Ottawa, ON, Canada

Highlighted Posters from the Indian Association of Surgical Oncology

GP8 A Randomized Controlled Trial Comparing the Efficacy of Methylene Blue Dye Alone versus Combination of Methylene Blue Dye and Radio active Sulphur Colloid in Sentinel Lymph Node Biopsy for Early Stage Breast Cancer Patients

Vikas Gupta, MBBS, MS

Basavatarakam IndoAmerican Cancer Hospital and Research Institute, Hyderabad, Telangana, India

GP9 Off-clamp Technique Partial Nephrectomy Feasibility and Impact on Renal Functional Outcome: A Single Institute Experience in South Indian Patients

Sivakumar Mahalingam, MBBS, MS, MCH, DNB

Cancer Institute (WIA), Chennai, Tamilnadu, India

GP10 Optimizing Neck Management in Early Buccal Carcinomas: The Jury is Still Out

Naveen Padmanabhan, MBBS, MS, MRCS

All India Institute of Medical Sciences (AIIMS), New Delhi, Delhi, India

GP11 Outcomes After Minimally Invasive Esophagectomy: Experience from Tertiary Cancer Centre from India

Satish Pawar, DNB

Basavatarakam IndoAmerican Cancer Hospital and Research Institute, Hyderabad, Telangana, India

GP12 Is it Feasible to Perform Sentinel Lymph Node Biopsy with Only Blue Dye in Early Oral Cancer? A Large Cancer Center Experience

Jeewan Ram, MBBS, MS, MCh

All India Institute of Medical Sciences (AIIMS), Jodhpur, Rajasthan, India

GP13 Prognostic Factors and Survival of Carcinoma of Breast in Women Aged 35 Years or Less: A Tertiary Health Center Study

Ankitbhai A. Shah, MBBS, MS, DNB

Mahavir Cancer Sansthan & Research Center, Patna, Bihar, India

GP14 Does Histology Dictate the Outcome of Locally Advanced Rectal Adenocarcinoma with Complete Pathological Response following Chemoradiation?

Rajesh S. Shinde, MCh

Tata Memorial Hospital, Mumbai, Maharashtra, India

GP15 Prognosis and Multivariant Analysis of N2c in Oral Cavity Squamous Cell Carcinomas: A 10-Year Study at Tertiary Cancer Hospital in South India

Jagadish Singh Alluru

Government Kilpauk Medical College and Govt. Royapettah Hospital, Chennai, Tamilnadu, India

GP16 Role of 18F-FDG PET/CT in Management of Clinically Node Negative Neck in Carcinoma Oral Cavity

Anushree Anup Vartak, MBBS, MS

Army Hospital Research & Referral, Delhi, Delhi, India

GP17 Prospective Study on ER, PR, HER 2- NEU, Ki67 Expression and Discordance Patterin in Recurrent and/or Metastatic Carcinoma Breast and Its Therapeutic Implications

Maheswaran Satishkumar, MCh

Regional Cancer Centre, Madurai Medical College, Madurai, Tamilnadu, India

Highlighted Posters from the Japanese Society of Gastroenterological Surgery

GP18 Postoperative Complications and Long-term Prognosis of Gastric Cancer in Patients Over 80 Years Old

Yusuke Taki, MD

Shizuoka General Hospital, Shizuoka, Shizuoka Prefecture, Japan

Highlighted Posters from the Korean Society of Surgical Oncology

GP19 Prognostic Role of Body Mass Index in the Long-term Survival of Gastric Cancer Patients and the Relation Between Preoperative Body Mass Index and Weight Loss

Young Suk Park, MD

*Seoul National University Bundang Hospital,
Seongnam-shi, Kyeonggi-do, South Korea*

GP20 Methylation of the NT5E Gene is Associated with Poor Prognostic Factors in Breast Cancer

Hye Ryeon Choi, MD

*Daegu Catholic University Medical Center,
Namgu, Daegu, South Korea*

GP21 Identifying the Anti-Cancer Effects of Acetyl-CoA Carboxylase Alpha Derived from TCGA Data in Colorectal Cancer

Sanghee Kang, MD, PhD

*Korea University College of Medicine, Seoul,
South Korea*

GP22 Should the Extent of Lateral Neck Dissection be Different for Papillary Thyroid Microcarcinomas?

Joon Hyop Lee, MD

*Gachon University Gil Medical Center, Incheon,
South Korea*

GP23 Effects of an Internet-based Informational Video on Preoperative Anxiety in Patients with Colorectal Cancer

Heung-Kwon Oh, MD

*Seoul National University Bundang Hospital,
Seongnam, Bundang-gu, Republic of Korea*

GP24 Bevacizumab/FOLFIRI in Combination with Ginsenoside-Modified Phospholipid Liquid Crystal Containing Curcumin for Colorectal Cancer Patients with Unresectable Metastasis: Interim Report

Jeong-Heum Baek, MD, PhD

*Gachon University Gil Medical Center,
Incheon, Korea*

SCIENTIFIC POSTERS

POSTER PRESENTATIONS

NOT
FOR
CREDIT

Posters will be displayed by disease site this year. All Thursday Scientific Posters (PT) will be displayed from 9:30 am-7:30 pm, Thursday, March 22 and all Friday Scientific Posters (PF) will be displayed from 9:45 am-4 pm on Friday, March 23. Presenters are requested to be available during exhibit hall breaks, as their schedules permit, to answer questions about their posters. Poster signage is color-coded by track.

(PT) THURSDAY, MARCH 22

Pink	Breast Track
Light Blue	Gastrointestinal Track (Hepato-pancreato-biliary)
Green	Quality Improvement/Clinical Outcomes
Orange	Other Surgical Oncology Track (Endocrine; Head & Neck; Thoracic)
Purple	Global Partner Posters (Available both days)

(PF) FRIDAY, MARCH 23

Dark Blue	Colorectal Track
Light Blue	Gastrointestinal Track (Upper Gastro intestinal)
Green	Quality Improvement/Clinical Outcomes
Red	Melanoma Track
Yellow	Sarcoma Track
Purple	Global Partner Posters (Available both days)

Poster Grand Rounds participants will be marked with a star in the Poster Hall. See the SSO Events mobile app for full SSO 2018 information and schedule.

DISCLOSURE POLICY AND DISCLOSURES

In accordance with the ACCME's Accreditation Criteria and the Society of Surgical Oncology (SSO) policy, all educational planners, presenters, instructors, moderators, authors, reviewers and other individuals in a position to control or influence the content of an activity must disclose all relevant financial relationships with any commercial interest that have occurred within the past 12 months. This includes the disclosure of financial relationships of a spouse or partner. The ACCME considers financial relationships to create conflicts of interest when individuals have both a financial relationship with a commercial interest and the opportunity to affect the content of CME about the products or services of that commercial interest. The ACCME defines a commercial interest as "any entity producing, marketing, reselling, or distributing health care goods or services consumed by, or used on, patients." ACCME does not consider providers of clinical service directly to patients to be commercial interests.

All identified conflicts of interest must be resolved and the educational content thoroughly vetted for fair balance, scientific objectivity, and appropriateness of patient care recommendations. It is required that disclosure be provided to the learners prior to the start of the activity. Individuals with no relevant financial relationships must also inform the learners that no relevant financial relationships exist. Learners must also be informed when off-label, experimental/investigational uses of drugs or devices are discussed in an educational activity or included in related materials. Disclosure in no way implies that the information presented is biased or of lesser quality. It is incumbent upon course participants to be aware of these factors in interpreting the program contents and evaluating recommendations. Moreover, expressed views do not necessarily effect the opinions of the SSO.

All identified conflicts of interest have been resolved.

You may view all Faculty, Moderators, Planners, Reviewers and staff that have disclosed financial relationships with commercial interests in our SSO Events mobile app or by visiting eventmobi.com/SSO2018.

All other SSO 2018 Faculty, Moderators, Planners, Reviewers and staff disclosed they have no relevant financial relationship(s) with any entity producing, marketing, re-selling, or distributing health care goods or services consumed by, or used on, patients.

INDUSTRY FORUM

NOT
FOR
CREDIT

Genentech, Inc.

Presurgical Considerations for Patients With Early Breast Cancer

6:45–7:45 am, Thursday, March 22

Room E353c

Breakfast Provided

Presenter: Julie Margenthaler, MD

Executive Summary: Join us for a surgeon-focused, surgeon-led, interactive program.

Program Overview:

- Exploration of current ASCO/CAP testing recommendations and the association between tumor biology and treatment decisions prior to surgery
- Review of current surgical guidelines and considerations for patients who have received pre-operative systemic therapy
- Interactive case-study-based discussions on the role of the multidisciplinary team

EXHIBIT HALL THEATER PRESENTATION

NOT
FOR
CREDIT

Amgen, Inc.

12:30–1:15 pm, Thursday, March 22

Exhibit Hall Theater, Exhibit Hall D1

Lunch Provided

Clinical Considerations For Treatment In Advanced Melanoma

This program is meant to educate healthcare providers on an advanced treatment option covering efficacy, dosing, administration, and safety information. The session will also include a video demonstration of the injection technique for healthcare providers.

Presenter: John H. Stewart IV, MD, MBA
Associate Professor of Surgery
Duke University School of Medicine, Durham, NC

EXHIBITS

The Exhibit Hall is located in Hall D1.

American Association for Cancer Research

Booth: 514

*615 Chestnut Street, 17th Floor, Philadelphia,
PA 19106-3483*

Phone: 215-646-0678

www.aacr.org/

American Joint Committee on Cancer

Booth: 504

633 N. Saint Clair Street, Chicago, IL 60611

Phone: 312-202-5313

www.facs.org

The American Joint Committee on Cancer (AJCC) established the way cancer is communicated. Clinicians and the surveillance community count on AJCC for the most comprehensive anatomic staging data available, the Cancer Staging Manual and Cancer Staging Atlas.

American Society of Clinical Oncology (ASCO)

Booth: 714

2318 Mill Road, Suite 800, Alexandria, VA 22314

Phone: 888-282-2552

www.asco.org

What do you need? ASCO membership supports your efforts to enhance quality, increase efficiency, and keep pace with innovations in cancer care. Join ASCO or renew your membership while at the meeting and receive a free gift!

Amgen

Booth: 1002, 1102

One Amgen Center Drive, Thousand Oaks, CA 91320

Phone: 805-447-1000

www.amgen.com

Amgen is committed to unlocking the potential of biology for patients suffering from serious illnesses by discovering, developing, manufacturing and delivering innovative human therapeutics. This approach begins by using tools like advanced human genetics to unravel the complexities of disease and understand the fundamentals of human biology. Amgen focuses on areas of high unmet medical need and leverages its biologics manufacturing expertise to strive for solutions that improve health outcomes and dramatically improve people's lives. A biotechnology pioneer since 1980, Amgen has grown to be one of the world's leading independent biotechnology companies, has reached millions of patients around the world and is developing a pipeline of medicines with breakaway potential.

AngioDynamics Inc.**Booth: 507***14 Plaza Drive, Latham, NY 12110*

Phone: 518-795-1400

www.AngioDynamics.com

A leading provider of innovative, minimally invasive medical devices used by professional healthcare providers for vascular access, surgery, peripheral vascular disease and oncology. Our diverse product lines include market-leading ablation systems, fluid management systems, vascular access products, thrombolytic products and venous products.

Annals of Surgical Oncology**Booth 616**www.annsurgoncol.org

Now celebrating a 25-year anniversary, *Annals of Surgical Oncology* (ASO) promotes the field of surgical oncology by communicating advances in research and education that are relevant and valuable to the provision of multidisciplinary care for patients with cancer. ASO is the most cited surgical oncology journal and one of the most cited surgical journals in the world with nearly 14,000 citations in 2016 to articles published within the last five years. ASO's five-year impact factor is 4.392 and has achieved over 970,000 article downloads since 2005.

AntiCancer PDOX, Inc.**Booth: 403***7917 Ostrow Street, San Diego, CA 92111*

Phone: 858-654-2555

www.anticancer.com

World leader and pioneer in metastatic patient-derived orthotopic xenograft (PDOX) mouse models for precision medicine for individual patients, drug discovery and contract research since 1984.

Belmont Instrument Corporation**Booth: 505***780 Boston Road, Billerica, MA 01821*

Phone: 978-663-0212-124

www.belmontinstrument.com

The Belmont® Hyperthermia Pump is making hyperthermic therapy available for all patients. The affordable system uses patented electromagnetic induction technology precisely warms fluids to target temperature in a single pass. It is a safe, simple, efficient portable system.

BK Ultrasound**Booth: 509***8 Centennial Drive, Peabody, MA 01960*

Phone: 978-326-1300

www.bkultrasound.com

For over 30 years, BK Ultrasound has been a leader in the development of surgical ultrasound systems. With award-winning systems & advanced transducer designs, BK addresses the clinical challenges of oncological surgeons, offering unsurpassed imaging capabilities & enabling real-time image guidance with easy-to-use, state-of-the-art platforms.

Bristol-Meyers Squibb**Booth: 916***3401 Princeton Pike, Lawrenceville, NJ 08648*

Phone: 609-302-3000

www.bms.com

Bristol-Myers Squibb is a global biopharmaceutical company focused on discovering, developing and delivering innovative medicines for patients with serious diseases. We are focused on helping patients in disease areas including oncology, cardiovascular, immunoscience and fibrosis. Each day, our employees work together for patients – it drives everything we do.

Cardinal Health – LYMPHOSEEK**Booth: 307***7000 Cardinal Place, Dublin, OH 43017*

Phone: 614-553-4960

www.lymphoseek.com

Cardinal Health, Inc. is a Fortune 25 company bringing scaled solutions to those tasked with navigating the complexities of healthcare. Nuclear Pharmacy Services has 40+ years of expertise and is a national source for both SPECT and PET radiopharmaceuticals, operating the largest network of 130 pharmacies and 30+ cyclotron facilities.

Carl Zeiss Meditec, Inc.**Booth: 803***5160 Hacienda Drive, Dublin, CA 94568*

Phone: 925-557-4854

www.meditec.zeiss.com

Carl Zeiss Meditec AG's extensive portfolio encompasses the unique ZEISS INTRABEAM® Radiotherapy System for intraoperative radiotherapy. The ZEISS INTRABEAM Radiotherapy system provides additional radiotherapy options for a wide range of tumors as for example Breast cancer, Spinal Metastases, Gastrointestinal Tumors, Skin Cancer or Brain tumors.

Carle Physician Group**Booth: 1105***611 W. Park Street, Urbana, IL 61801*

Phone: 217-840-5262

www.carleconnect.com

Carle Physician Group, a 400+ physician multispecialty group in Champaign-Urbana, is part of a not-for-profit integrated network of healthcare services that includes Carle Foundation Hospital, a 393-bed Magnet® Level I Trauma Center with Level III perinatal services, and clinics located in 19 communities throughout Illinois.

Castle Biosciences, Inc.**Booth: 702***820 S. Friendswood Drive, Suite 201,**Friendswood, TX 77546*

Phone: 866-788-9007

www.castlebiosciences.com

Castle Biosciences is a provider of molecular diagnostics to improve cancer treatment decisions. DecisionDx®-Melanoma uses tumor biology to provide an individual risk of melanoma recurrence beyond traditional factor such as AJCC staging criteria and sentinel lymph node status. DecisionDx®-UM enables accurate staging of five-year metastatic risk in uveal melanoma and is standard of care in a majority of ocular oncology practices.

Cianna Medical**Booth: 407***6 Journey, Suite 125, Aliso Viejo, CA 92656*

Phone: 949-360-0059

www.ciannamedical.com

Cianna Medical, the world leader in wire-free breast localization, focuses on expanding applications that continually advance patient care and reduce the anxiety and stress breast cancer treatments place on women and their families. Its SCOUT® radar localization and SAVI® Brachy technologies are FDA cleared and address unmet needs in tumor localization, surgical guidance and the delivery of radiation therapy.

City of Hope National Medical Center**Booth: 816***4920 Rivergrade, Human Resources Talent Acquisition, Irwindale, CA 91760*

Phone: 626-218-9831

www.cityofhope.org

City of Hope is an internationally recognized leader in the research and treatment of cancer. An NCI designated comprehensive cancer center, U.S. News and World Report has named us one of the top cancer hospitals in America for more than a decade. We are founding members of the National Comprehensive Cancer Network and were selected as one of the first centers in the nation - and the sole location in Southern California, upon launch - designated to the first CAR-T cell therapy approved by the U.S. Food and Drug Administration for adult patients with refractory aggressive non-Hodgkin lymphoma.

CivaTech Oncology, Inc.**Booth: 513***2810 Meridian Parkway, Durham, NC 27713*

Phone: 919-314-1515

www.civatechoncology.com

CivaTech Oncology is dedicated to localized therapy using radioactive polymers. The implantable CivaSheet features a flexible bioabsorbable membrane embedded with palladium and custom shielded with gold- Gold is cold. CivaSheet is the only directional brachytherapy device designed to treat cancerous tissue while protecting healthy tissue nearby- IORT made simple.

Clinical Genomics Inc.**Booth: 1103***1031 US Highway 202/206, Suite 100, Bridgewater, NJ 08807*

Phone: 412-980-1149

www.colveratest.com

Clinical Genomics is leading provider of cancer diagnostic solutions, offering COLVERA™, a new liquid biopsy test identifying ctDNA in patients post-treatment for early detection of CRC recurrence and post-surgery for detection of residual disease, and InSure® ONE™, a fecal immunochemical test used in screening programs for healthy adults. Clinical Genomics continues to apply its proprietary innovation in molecular pathology to commercialize other diagnostic tools in other cancer types.

Decker Intellectual Properties Inc.**Booth: 819**

*PO Box 57038 Jackson Square, Hamilton,
ON L8P 3M4 Canada*
Phone: 855-647-6511
www.deckerip.com

Complex General Surgical Oncology is an official publication of SSO. It is a new educational platform for surgeons in training and in practice for life long learning. From preparing for boards to satisfying CME to handling MOC, you will find CGSO provides one stop shopping to keep you on top of the latest information.

Dune Medical Devices, Inc.**Booth: 1018**

*6120 Windward Parkway, Suite 160,
Alpharetta, GA 30005*
Phone: 855-597-3863
www.dunemedical.com

The MarginProbe® System is an FDA approved margin assessment device that significantly improves the breast surgeon's ability to intra-operatively identify cancer on the margins of excised tissue during a lumpectomy, helping to reduce the positive margin rate following the initial lumpectomy procedure.

Edward-Elmhurst Health**Booth: 705**

801 S Washington Street, Naperville, IL 60540
Phone: 630-527-3207
www.eehealth.org

Eight Medical**Booth: 907**

345 S. College Avenue, Suite 103, Bloomington, IN 47403
Phone: 812-822-0404
www.eightmedical.com

Our leading technology, the Recirculator 8.0, is an FDA-cleared and CE-approved medical device designed specifically for Intraperitoneal Hyperthermia and Intrathoracic Hyperthermia. Reliable, mobile, easy to use, the Recirculator is equipped with a disposable reservoir (no waterbath) allowing improved safety for the patient and the OR staff.

Ethicon**Booth: 502**

4545 Creek Road, Cincinnati, OH 45242
Phone: 877-384-4266
www.ethicon.com

Ethicon US LLC, a Johnson & Johnson company, commercializes a broad range of innovative surgical products, solutions and technologies used to treat some of today's most prevalent medical issues, such as: colorectal and thoracic conditions, women's health conditions, hernias, cancer and obesity.

Faxitron**Booth: 602**

3440 East Britannia Drive, Suite 150, Tucson, AZ 85706
Phone: 520-399-8180
www.faxitron.com

As a worldwide leader in digital radiography, Faxitron® has been pioneering solutions for medical imaging applications in women's health for over 50 years. We are committed to developing innovative products and exploring advancements in the areas of breast surgery, stereotactic biopsy, breast lesion localization and pathology. We have an installed base of over 8000 systems around the globe and all top 10 US cancer centers have at least one Faxitron system.

Focal Therapeutics**Booth: 613**

30 Enterprise, Suite 220, Aliso Viejo, CA 92656
Phone: 949-600-5050
www.focalrx.com

BioZorb is a 3D, bioabsorbable implant that is placed at the time of tissue excision, delineating the surgical site and helping to visualize the area on clinical imaging. Physicians using BioZorb have shown its clinical utility across many aspects of breast cancer care, including oncoplastic surgery, radiation therapy and long term follow-up.

Genentech, A Member of the Roche Group **Booth: 402**

1 DNA Way, South San Francisco, CA 94080
Phone: 650-225-1000
www.gene.com

For more than 40 years, we've been following the science, seeking solutions to unmet medical needs. As a proud member of the Roche Group, we make medicines to treat patients with serious medical conditions. We are headquartered in South San Francisco, California.

Genomic Health, Inc.**Booth: 713**

301 Penobscot Drive, Redwood City, CA 94063
Phone: 866-662-6897
www.oncotypedx.com

The Oncotype DX® portfolio of breast, colon and prostate cancer tests applies advanced genomic science to reveal the unique biology of a tumor in order to optimize cancer treatment decisions. With more than 800,000 patients tested in more than 90 countries, the Oncotype DX tests have redefined personalized medicine by making genomics a critical part of cancer diagnosis and treatment. To learn more about Oncotype DX tests, visit www.OncotypeIQ.com.

Hackensack Meridian Health**Booth: 814***1967 Highway 34, Building C, Suite 104, Wall, NJ 07719*

Phone: 732-751-3561

www.hackensackmeridianhealth.org/

Hackensack Meridian Health is a leading not-for-profit health care network in New Jersey offering a complete range of medical services, innovative research, and life-enhancing care aiming to serve as a national model for changing and simplifying health care delivery through partnerships with innovative companies and focusing on quality and safety.

Health Volunteers Overseas**Booth: 704***1900 L Street NW, Suite 310, Washington, DC 20036*

Phone: 202-296-0928

www.hvoua.org

Health Volunteers Overseas is a nonprofit organization that seeks to improve global health through education of the local health workforce in resource-scarce countries. The success of our programs depends upon volunteers who donate their time and expertise to work side-by-side with their colleagues overseas. Their work improves patient care by bringing skills and knowledge to health care providers and building the capacity of health systems to address the health care needs of their communities.

Hitachi Healthcare**Booth: 411***1959 Summit Commerce Park, Twinsburg, OH 44087*

Phone: 800-800-3106

www.hitachihealthcare.com

Hitachi Healthcare's commitment to ultrasound for surgeons offers a wide range of consoles and specifically designed transducers to meet the needs of every surgeon. Recognized for our superior image quality, system reliability and use of cutting edge technology, we remain the standard in the field of ultrasound for surgeons.

IntraMedical Imaging LLC**Booth: 904***12569 Crenshaw Boulevard, Hawthorne, CA 90250*

Phone: 844-426-6277

www.GammaProbe.com

IMI markets a family of surgical probes including Surgical Gamma Probes for sentinel lymph node biopsy in breast cancer and melanoma surgery, and PET Probes for intraoperative Gamma Probe and Beta Probe tumor detection and surgical margin evaluation. Our technology is based on the injection of radio-pharmaceuticals that emit gamma or beta rays. Surgeons use our probes to locate the sentinel lymph nodes or cancerous tissues that accumulate the radio-pharmaceuticals.

Invuity**Booth: 804***444 De Haro Street, San Francisco, CA 94107*

Phone: 415-655-2178

www.invuity.com

Invuity, Inc. is a medical technology company focused on developing and marketing advanced photonics devices to improve the ability of surgeons to illuminate and visualize the surgical cavity during open minimally invasive and minimal access surgery.

Lumicell**Booth: 801***80 William Street, Suite 2-260, Wellesley, MA 02481*

Phone: 508-737-4042

www.lumicell.com

Lumicell is a technology leader in the field of image-guided cancer surgery. The company's LUM system enables real-time detection of tumor tissue in patients so that no cancer cells are left behind during surgery. The LUM System allows surgeons to see and remove cancer cells remaining in the surgical cavity – beyond the margin of the specimen – and has the potential to significantly improve surgical outcomes and reduce healthcare costs by eliminating the need for repeat surgeries.

Mammotome**Booth: 302***300 E-Business Way, 5th Floor, Cincinnati, OH 45241*

Phone: 513-864-9028

www.mammotome.com

Mammotome® revolve™, a new dual-vacuum assisted biopsy platform, is the only device to offer advanced tissue management technology, providing touch-free tissue collection in numbered, pathology-ready chambers to preserve tissue integrity. Mammotome elite® is the only single-insertion, tetherless device with TruVac™ vacuum technology.

Medical Engineering Innovations, Inc.**Booth: 1004***3591 Anderson Street, Suite 214, Madison, WI 53704*

Phone: 608-239-9352

www.mei-america.com

Medical Engineering Innovations, Inc. believes that procedure-specific surgical devices can provide better survival rates and reduce healthcare costs. We develop and commercialize energy based medical devices that meet unmet needs, advance patient care, improve quality of life and achieve better healthcare cost-effectiveness.

Medtronic**Booth: 902***710 Medtronic Parkway, Minneapolis, MN 55432*

Phone: 763-514-4000

www.medtronic.com

As a global leader in medical technology, services and solutions, Medtronic improves the lives and health of millions of people each year. We use our deep clinical, therapeutic and economic expertise to address the complex challenges faced by healthcare systems today. Let's take healthcare Further, Together. Learn more at Medtronic.com.

Merck & Co., Inc.**Booth: 303***2000 Galloping Hill Road, Kenilworth, NJ 07033*

Phone: 908-740-4000

www.merck.com

For more than a century, Merck has been inventing for life, bringing forward medicines and vaccines for many of the world's most challenging diseases. Today, Merck continues to be at the forefront of research to deliver innovative health solutions and advance the prevention and treatment of diseases that threaten people and animals around the world.

Nature Hill NV**Booth: 807***8550 West Desert Inn Road, Las Vegas, NV 89117*

Phone: 312-361-7775

<http://www.naturehillnv.com>**Novartis Oncology****Booth: 407***One Health Plaza, East Hanover, NJ 07936*

Phone: 862-778-7358

www.novartisoncology.com

Novartis Oncology has emerged as a global leader in oncology through targeted research and open partnership in the pursuit of new therapies capable of transforming outcomes for people with cancer. Our research is driven by a distinctive scientific and clinical strategy, focusing on unmet medical needs and disease pathways. For more information, visit www.novartisoncology.com.

Oncovision**Booth: 604***30 Newbury Street, 3rd Floor, Boston, MA 02116*

Phone: 617-892-1057

www.oncovision.com

Oncovision is a leading provider of innovative medical imaging devices for the diagnosis and treatment of cancer. We boast a clinical product line that includes Sentinella, a unique intra-operative Gamma Camera and the revolutionary Mammi, a dedicated breast PET. Completes its portfolio with Wprobe, the gold standard in radio guided surgery, finally we develop CareMiBrain a new brain-dedicated PET. Discover more at www.oncovision.com and www.mammibreastcare.com.

Pacira Pharmaceuticals, Inc.**Booth: 802***5 Sylvan Way, Parsippany, NJ 07054*

Phone: 973-254-3560

www.pacira.com

Pacira Pharmaceuticals, Inc. (NASDAQ: PCRX) is a specialty pharmaceutical company focused on the clinical and commercial development of new products that meet the needs of acute care practitioners and their patients.

PreludeDx**Booth: 404***26051 Merit Circle, Suite 102, Laguna Hills, CA 92653*

Phone: 949-348-1188

www.preludedx.com

PreludeDx is offering DCISionRT--the only predictive test developed specifically to address the challenging decision DCIS patients and their physicians face when determining treatment following breast conserving surgery. Now you can make decisions with biological insight that includes prediction of radiation therapy benefit.

Riverside Health System**Booth: 1013***701 Town Center Drive, Suite 1000**Newport News, VA 23606*

Phone: 757-224-4990

www.riversideonline.com

Riverside Medical Group (RMG) is a 500+ provider multi-specialty clinical team that is the heart of one of America's strongest healthcare delivery organizations. The Riverside system is over 100 years old and, in addition to recognized strength in areas such as neurosciences, cardiac, and orthopedic care, has spent the past 30+ years successfully building unique differentiation in elder care, rehabilitation, home-based technologies, wellness and mental health support.

Sirtex Medical Inc.**Booth: 511***300 Unicorn Park Drive, Woburn, MA 01801*

Phone: 888-474-7839

www.sirtex.com

Sirtex develops oncology treatments using novel small particle technology to improve outcomes for patients with cancer. SIR-Spheres® Y-90 resin microspheres target liver tumors with radiation via the hepatic artery during Selective Internal Radiation Therapy (SIRT). Data shared at the 2015 ASCO Annual Meeting showed a 7.9 month improvement in Progression-Free Survival in the liver for patients with unresectable mCRC treated first line with SIR-Spheres microspheres plus standard chemotherapy.

Society of Surgical Oncology**Booth: 616***9525 West Bryn Mawr Avenue, Suite 870**Rosemont, IL 60018*

Phone: 847-427-1400

www.surgonc.org

The Society of Surgical Oncology (SSO) is the premier organization for cancer surgeons and health care providers dedicated to improving multidisciplinary patient care by advancing the science, education and practice of cancer surgery worldwide. As the spectrum of innovative treatments grows day by day, we invite you to become an SSO member to expand your knowledge and network of peers. Stop by booth 616 to learn more about member benefits, including ExpertEd@SSO. Join during SSO 2018 and the \$150 application fee will be waived.

The Cancer Programs of the American College of Surgeons

Booth: 504

633 N. Saint Clair Street, 25th floor - Cancer Department, Chicago, IL 60611

Phone: 312-202-5313

www.facs.org/quality-programs/cancer

The American College of Surgeons Cancer Programs will be exhibiting at SSO2018, and include the American Joint Committee on Cancer, the Alliance/ACS Clinical Research Program, the Commission on Cancer, the National Accreditation Program for Breast Centers, and the National Accreditation Program for Rectal Cancer.

ThermaSolutions, Inc.

Booth: 707

1889 Buerkle Road, White Bear Lake, MN 55110

Phone: 651-209-3900

www.thermasolutions.com

ThermaSolutions is recognized as the global leader in Hyperthermic Technology providing fully integrated systems designed and manufactured for intraperitoneal hyperthermia (IPH). Currently utilized in more than 200 Oncology Centers throughout the USA, Europe and the Middle East. TSI has partnered with Genesis Medical Group to provide world class training and surgical support to new customers. Surgeons have come to rely on the talents of Genesis Medical and the reliability of ThermaSolutions.

Thompson Surgical Instruments, Inc.

Booth: 409

10170 E Cherry Bend Road, Traverse City, MI 49684

Phone: 231-922-0177

www.thompsonsurgical.com

Thompson Surgical celebrates 50 years as a leader in exposure and the original manufacturer of the table-mounted retractor. We understand the value of exposure in surgery and are dedicated to providing innovative, high quality systems delivering safe, versatile, low-profile retraction. We offer unlimited customization and Uncompromised Exposure.

TS Medical USA

Booth: 607

8255 Las Vegas Boulevard, S, Las Vegas, NV 89123

Phone: 702-782-3553

www.tsmedicalusa.com

University of Florida Health

Booth: 309

1239 SW 16th Street, Suite 3120, Gainesville, FL 32605

Phone: 352-258-4079

www.ufhealth.org

The brain tumor team at UF Health consists of many highly skilled specialists working together to develop and deliver the most optimal treatment plans. Our scientists are working to cure brain cancer. Our neurosurgeons are operating with extreme precision. Our radiologists provide us with the most advanced imaging. Our medical oncologists are skilled in effective medication treatment. Our pathologists are able to determine tumor types with utmost accuracy.

Vector Surgical, LLC**Booth: 614***20975 Swenson Drive, Suite 430, Waukesha, WI 53186*

Phone: 262-798-7970

www.vectorsurgical.com

Vector Surgical offers devices that improve outcomes in cancer surgery. The Tissue Orientation System, comprised of MarginMarker sterile inks and CorrectClips radiographic clips, provides secure and accurate designation of specimen margins. SilversteinWrap is a unique post-surgical, post-biopsy compression dressing that improves outcomes in breast surgery.

Wolters Kluwer**Booth: 813***Two Commerce Square, 2001 Market Street**Philadelphia, PA 19103*

Phone: 215-521-8300

www.lww.com

Wolters Kluwer Health is a leading global provider of information and point of care solutions for the healthcare industry. Our solutions are designed to help professionals build clinical competency and improve practice so that healthcare organizations can succeed in value-based care delivery models. Product solutions include Lippincott, Ovid®, and UpToDate®

FACULTY INDEX

Abbott, D.E.....	17,45	Cassidy, M.R.....	36
Alapati, A.....	54	Castelli, A.A.	54
Aleassa, E.M.....	71	Chan, E.Y.	36
Alexander, Jr., H.R.	15,72	Chang, E.	71
Alkhuziem, M.	71	Chang, G.J.....	56,63,64,69
Allen, P.J.....	17,48	Chen, H.....	40
Alluru, J.S.	77	Chesney, T.R.	75
Allweis, T.M.	45	Cho, C.S.....	37,47
Aloia, T.A.	39,45,48,62	Choi, H.R.....	78
Anderson, K.....	62	Chun, Y.S.....	57
Angeles, C.V.....	36	Clarke, C.N.	36
Ariyan, C.E.	58	Clary, B.M.....	17,39
Asare, E.A.....	40	Coburn, N.	76
Audisio, R.A.....	69	Coimbra, F.J.F.	57
Auer, R.C.....	17,37,66	Coit, D.G.....	14,15,54
Austin, J.	58	Corvera, C.U.	39
Babcock, B.D.....	63	Crago, A.M.	38,66
Badgwell, B.D.....	72	Czerniecki, B.J.	17,62
Baek, J.	78	Dallas, N.A.....	17,36
Bagaria, S.P.....	17,37,72	D'Angelica, M.I.	57
Baker, J.L.	38	D'Angelo, O.....	40
Balch, C.M.....	3,7,10,14, 25,48,50,74	Dann, A.....	47
Balch, G.C.	56	Davis, C.H.	59
Banting, S.	58	Davis, J.L.....	36
Barreto-Andrade, J.C.	58	De La Cruz, L.M.....	36
Barron, A.U.	54	Deckers, E.A.	61
Barry, P.A.	58	Dehal, A.....	60
Bartlett, E.	61	Delach, F.	54
Baumgartner, J.....	57	Delman, K.A.....	17,37
Bednarski, B.K.	36	DeMatteo, R.P.	37
Bedrosian, I.....	58	Dhar, V.K.	69
Bello, D.M.....	57	Dhir, M.....	57
Bentrem, D.J.....	17,41	Dickson, P.V.....	36
Bertolli, E.....	75	Dimick, J.B.	69
Bhutiani, N.	58,69	Dudeja, V.	68
Bilimoria, K.Y.....	14,45	Eberlein, T.J.	40
Blazer, D.....	72	Egger, M.E.	45
Boland, G.M.	36	Eggermont, A.M.M.....	44
Boughey, J.C.....	45	Eilber, F.C.....	57
Boulva, K.....	71	Elliott, I.A.	55
Bouvet, M.	39	El-Tamer, M.B.....	45
Brady, M.S.....	61	Erdrich, J.....	61
Brenin, D.R.	40	Evers, B.M.....	25,43
Brennan, M.F.....	38,40	Fairweather, M.	72
Brouwer, N.P.M.	60	Fallon, E.A.	59
Brown, K.M.....	55	Faries, M.B.....	54,64
Bryan, D.....	63	Fayanju, O.M.....	58
Bubis, L.D.	59	Fayanju, L.	45
Canter, R.J.....	17,66,68	Feferman, Y.....	69
Carp, N.Z.....	14,59	Fernández-del	
Carpizo, D.R.....	62,68,69	Castillo, C.....	65
		Fields, R.C.....	17,40

Fiore, M.	70	Katz, M.H.G.	62
Fisher, A.	55	Kazazian, K.	41
Fisher, C.S.	54	Keller, J.	58
Fisher, S.B.	70	Kennedy, E.D.	73
Flanagan, M.	40	Khader, A.	59
Fleming, F.J.	73	Khadra, H.	59
Folkert, I.W.	46	Khakpour, N.	45
Fong, Y.	42	Killelea, B.	41
Gabriel, E.	58	Kim, J.Y.S.	45
Gagniere, J.	55	Kim, J.	38
Gamblin, T.C.	65,17	Kim, L.	39
Garcia-Aguilar, J.	69	Kim, T.	71
Giuliano, A.E.	14,15,53,57,74	Kingham, T.P.	65
Gladdy, R.	66	Kirane, A.	55
Goldin, A.N.	70	Klimberg, V.S.	38,40
Gong, J.	54	Knab, L.M.	41
Gooch, J.C.	58	Konishi, T.	60
Gray, K.D.	71	Konstantinidis, I.	60
Greenup, R.A.	41	Kothari, A.N.	41
Grobmyer, S.R.	71	Kovacs, T.	45
Gronchi, A.	49	Krasnick, B.A.	60
Grubbs, E.G.	39	Kruper, L.	65
Gupta, V.	76	LaFemina, J.	47
Hallet, J.L.	71	Lahat, G.	71
Han, D.	37	Lamb, E.P.	38
Hansen, N.M.	58	Landry, J.P.	46
Hao, X.	27,75	Lang, J.E.	17,38,57
Hardaway, J.C.	65	LaRocca, C.J.	59
He, J.	73	Leach, S.D.	26,67
Hendren, S.	73	Lee, A.Y.	36
Hendrikson, J.	60	Lee, A.	69
Henry, D.	61,38	Lee, J.S.	61
Hernandez, M.	55	Lee, J.	46,68
Heslin, M.J.	15,40	Leigh, N.L.	71
Hogg, M.E.	42	Leong, S.P.	58
Hoover, S.J.	45	Levine, E.A.	17,64,72
Howe, J.R.	14,18,66	Li, G.	72
Hughes, B.D.	60	Lin, M.	71
Huis in 't Veld, E.A.	72	Lina, J.	37
Hunt, K.K.	14,62	Lindberg, J.M.	55
Hurton, S.	38	Liu, J.	41
Hwang, E.S.	38,48	Lo, M.	61
Ikoma, N.	40,49	Lopez-Aguilar, A.G.	46,47
Isaacs, K.E.	58	Lorimer, P.D.	63
Jajja, M.R.	63	Louie, R.	38
Jakub, J.W.	48	Lovasik, B.P.	65
Jeruss, J.S.	38	Lowe, M.C.	54
Johnson, A.C.	70	Luke, J.J.	54
Johnston, F.M.	73	Lyra, J.S.	60
Kang, R.	61	Mahalingam, S.	76
Kang, S.	78	Maker, A.V.	17,36,37,54
Kaplan, B.J.	17,18,71	Makris, E.A.	70
Karakousis, G.C.	66	Mamounas, E.P.	62
Katsuta, E.	58	Marcadis, A.R.	46

Marcello, P.W.	56	Philips, P.	42
Marcus, E.A.	65	Pigazzi, A.	56
Marcus, R.K.	41	Plitas, G.	62
Margenthaler, J.A. ..	14,54,81	Pockaj, B.A.	17,62
Marincola Smith, P.	46	Poli, E.C.	63
Martel, A.B.	63	Polite, B.N.	40,66
Martin, II, R.C.G.	15,65	Poodt, I.	54
Massimino, K.P.	36	Posner, M.C.	37,40,64
McDonald, K.A.	54	Qadan, M.	17,36,65
McLaughlin, S.A.	18,37	Rakitin, I.	65
McLeod, R.S.	73	Ram, J.	76
McMasters, K.M.	3,12,14, ... 15,42,49,51,52,53,63,73,74	Ramos, M.F.K.P.	27,75
McRee, A.J.	47	Raoof, M.	59
Merchant, N.B.	48	Raut, C.P.	57
Merchant, S.	41	Reddy, S.	18,73
Meric-Bernstam, F.	38	Reyes, S.A.	41
Merrill, A.Y.	59	Ridgeway, C.	40
Milsom, J.W.	56	Rizzo, M.	65
Mittendorf, E.A.	62	Roh, M.	4,48
Mokdad, A.A.	41	Rombouts, A.J.M.	41
Monson, J.R.T.	73	Ross, M.I.	54
Moo, T.	54	Roxburgh, C.	49
Morrow, M.	14,15,68,74	Rubinstein, J.C.	69
Mosca, P.J.	58	Russo, A.E.	69
Mullen, J.T.	70	Sabel, M.S.	18,45
Nanda, R.	62	Sasaki, J.	38
Narayanan, S.	60,63	Satishkumar, M.	27,77
Nessim, C.	70,76	Saunders, A.	71
Neuman, H.	41	Savant, D.	58
Newton, A.D.	47	Schadde, E.	39
Nguyen, V.	41	Scheri, R.P.	17,39
Nijhuis, A.A.G.	61	Schmidt, B.	55
Nunley, R.M.	40	Schmidt, C.R.	69
Nurkin, S.J.	37	Schuitevoerder, D.	58
Nussbaum, D.P.	69	Scoggins, C.R.	17,18,37, 42,57
Offodile II, A.C.	40	Seewaldt, V.L.	38
Oh, H.	78	Seiser, N.	55
O'Leary, F.M.	58	Selleck, M.J.	41
Olino, K.	68	Senders, Z.	47
Olson, J.	59	Serrano, P.	47
Padmanabhan, N.	76	Shah, A.A.	77
Pandit, H.	55	Shen, P.	55
Panni, R.Z.	25,47,55	Shibata, D.	66
Parikh, A.	54	Shinde, R.S.	77
Park, D.J.	71	Shubeck, S.P.	41
Park, J.	63	Simoneau, E.	47
Park, Y.S.	28,78	Singer, S.	66
Paty, P.B.	56	Sinnamon, A.J.	61
Pawar, S.	76	Smith, H.G.	61,72
Perdikis, G.	37	Smith, J.J.	63
Perez, M.	58	Sohn, VY.	36
Peterson, C.Y.	36	Soliman, I.A.	58

Sosa, J.A.	14,62	von Holzen, U.....	71
Spitz, F.R.....	69	Vuong, B.	65
St. Hill, C.R.....	40	Walsh, S.	65
Staley, C.A.....	15,37,72	Wang, T.S.....	39
Starker, L. F.	36	Wasif, N.	37
Stevenson, M.G.....	70	Wayne, J.D.	61
Stiles, Z.E.....	72	Weber, S.M.	17,59
Stitzenberg, K.B.....	56	Weber, W.P.....	55
Strajina, V.....	46	Wei, I.H.	60
Strong, V.E.	42	Weiser, M.R.	64,66
Suarez-Kelly, L.P.....	41,70,72	Weitz, J.	73
Swallow, C.J.....	64	Weixler, B.....	63
Sylla, P.....	56	Wellington, J.M.....	55
Symer, M.	60	Whippen, D.....	48
Szor, D.J.	75	White, R.R.	40
Tadros, A.B.....	41	White, Jr., R.L.....	62
Takabe, K.	41,59	Wilke, L.G.....	37
Taki, Y.....	77	Williams, A.D.....	16,62
Tamirisa, N.....	55	Winchester, Sr., D.P.....	73
Tanabe, K.K.....	39	Witten, M.	38
Tchou, J.C.	40	Wong, S.L.....	14,45,74
Temple, L.	73	Wright, G.P.....	59
Thiels, C.A.	70	Xue, L.....	60
Thompson, J.....	54	Yakoub, D.	71
Tohme, S.	65	Yan, H.....	46
Torphy, R.....	47	Yang, A.D.....	46
Tseng, J.	72	Yeh, J.J.....	49
Turaga, K.K.....	17,72	Yen, T.W.F.....	17,46
Tyler, D.S.	14,40,74	Yeo, H.L.	17,36,69
Tzeng, C.	41	Yi, M.....	55
Ueno, H.....	73	Yohanathan, L.....	47
Unzeitig, G.W.....	54,62	Yoon, S.S.....	66
Uppal, A.	65	Yopp, A.....	71
van Eden, W.J.	63	You, Y.N.	62,66
van Steenhoven, J.....	59	Young, G.D.	37
Vande Walle, K.	70	Zager, J.S.....	14,54,65
Varley, P.R.....	59	Zeh, III, H.J.....	17,42,69
Vartak, A.A.....	77	Zureikat, A.H.	42
Velazquez, C.....	69		
Verver, D.	61		
Vicente, D.	71		
Vigneswaran, Y.....	71		
Vo, E.	69		

LAKESIDE LEVEL 2

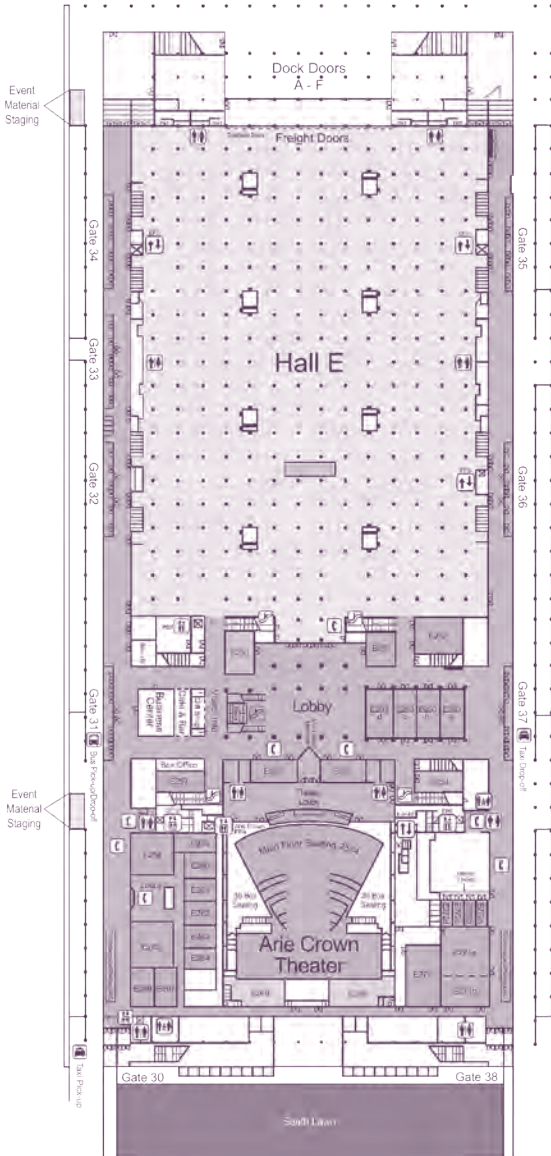

LAKESIDE LEVEL 3

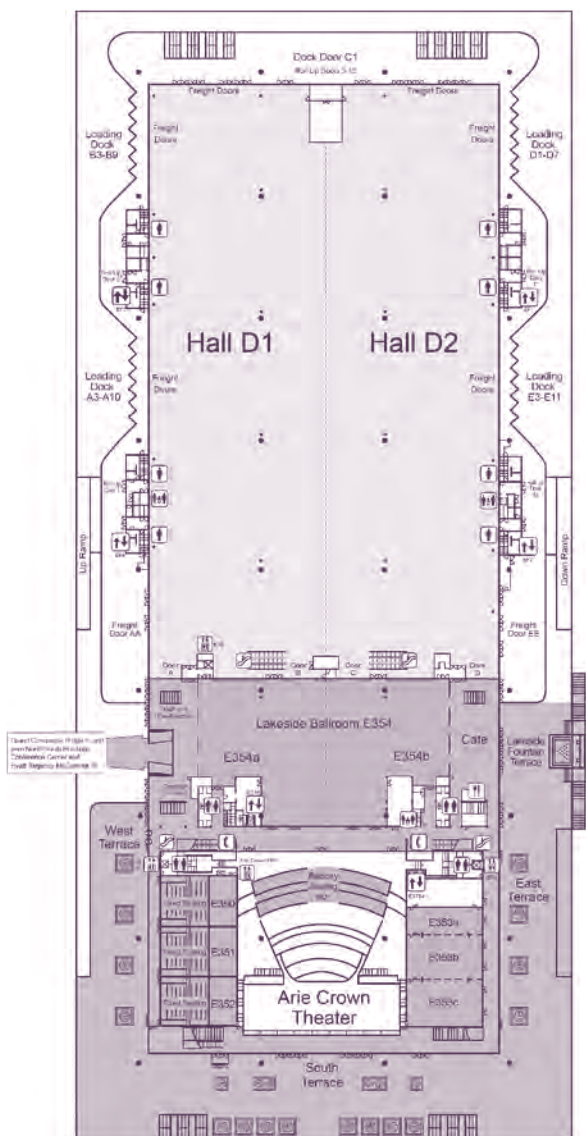

LAKE SIDE

LEVEL 4

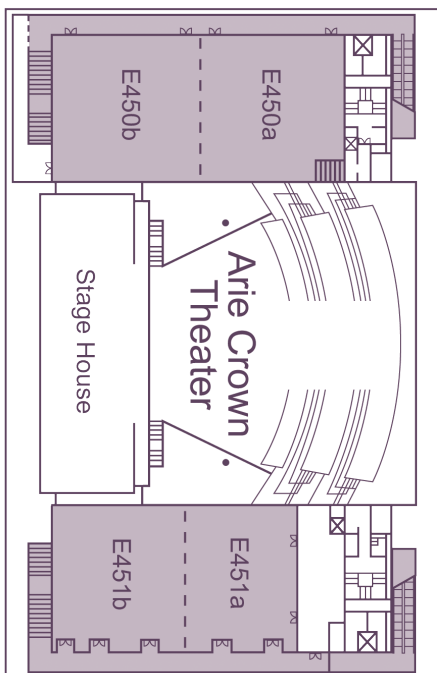

LAKE SIDE EXHIBIT HALL

SERVICES

SALES

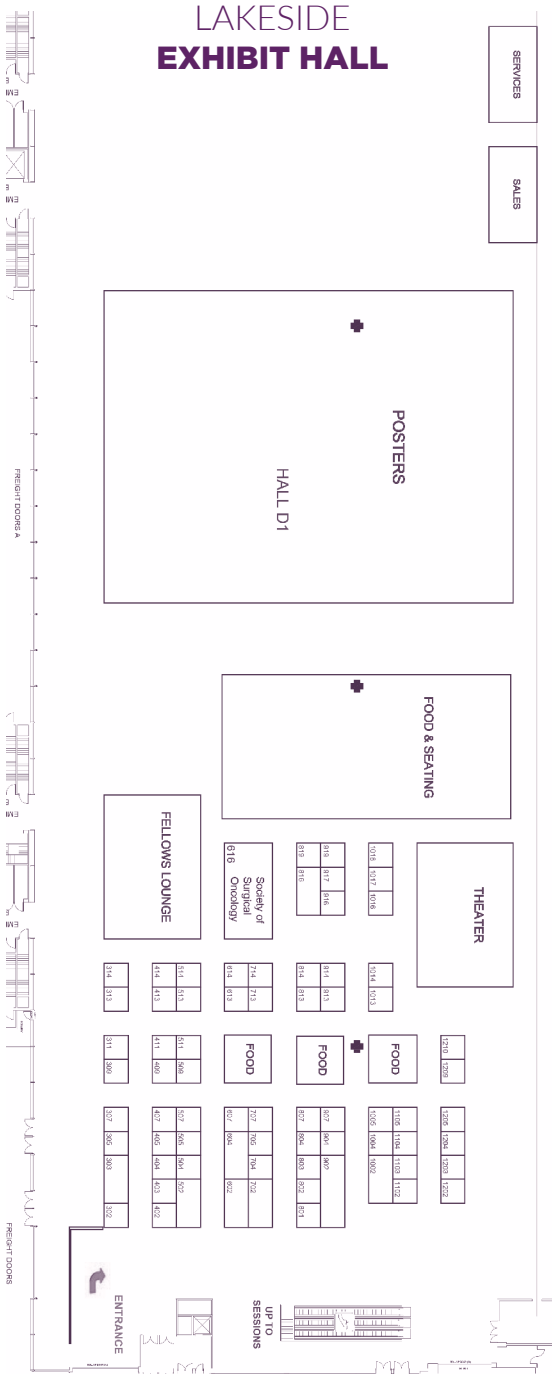



THE
SSO
FOUNDATION
Research. Education. Innovation.

Support The
SSO Foundation.

Text SSOFDONATE to 41444.

THE SSO FOUNDATION IS THANKFUL FOR YOU!

The SSO Foundation (SSOF) depends on individual donations from committed SSO members to underwrite:

- Research awards such as the Young Investigator Award and the Clinical Investigator Award;
- Educational programs such as the Fellows Institute;
- Lectures from distinguished speakers at the Annual Cancer Symposium, such as the James Ewing Lecture;
- Awards for Fellows and Residents, such as the Harvey Baker Traveling Fellow Award.

Every individual member donation illustrates SSO's passion for the discipline of surgical oncology, for the advancement of the science, and for improved patient outcomes.

Behind each new treatment, surgical instrument, or technique is the surgeon researcher that helped bring it from bench to reality, and the surgeon mentor that trained a future surgeon to use it. Your donations make a difference!

The SSO and The SSOF honors and celebrates its past, present, and future members and donors. Join your SSO colleagues who have made the commitment, and make your gift to The SSO Foundation at the SSO Membership Booth 616.

For a full listing of The SSO Foundation contributors, please consult the SSO 2018 Mobile App or view the SSO 2018 Donor Board.

FUTURE MEETINGS

MARCH 27-30, 2019 | SAN DIEGO, CA

MARCH 25-28, 2020 | BOSTON, MA

MARCH 24-27, 2021 | CHICAGO, IL

[illegible]

NOTES

[illegible]

WE

DON'T BELIEVE

THE FUTURE CAN WAIT

FOR THE FUTURE



Yuman Fong, M.D.



Yanghee Woo, M.D.



I. Benjamin Paz, M.D.



Laleh Melstrom, M.D., M.S.



Lily Lau Lai, M.D.



Laura Kruper, M.D., M.S.

We are City of Hope doctors, advancing science that saves lives. We have performed more than 14,000 bone marrow and stem cell transplants to treat cancer, with unparalleled survival rates for the past 13 consecutive years. Our research has led to the development of synthetic insulin and four of the most widely used cancer-fighting drugs. We are pioneers in the field of laparoscopic and robotic surgery, having performed more than 11,000 robotic procedures for prostate, kidney, colon, liver, bladder, gynecologic, oropharyngeal and other cancers. Today, we are helping to shape emergent techniques like gene editing and gene therapies for the treatment of human disease.

Find out more at **CityofHope.org**.





RAND

HYPERTHERMIC PERFUSION

EXTENDING PATIENT SURVIVAL



MARKET LEADER
PRESENT IN
30 COUNTRIES
WORLDWIDE

20.000

PATIENTS TREATED
WORLDWIDE

18

YEARS' EXPERIENCE
IN EXTENDING
PATIENT
SURVIVAL



RAND ACADEMY:
MASTER EXPERIENCE
IN SURGICAL
ONCOLOGY

Distributed by



PERFUSION.COM
SERVICE · SUPPLIES · SUPPORT

Phone: 888-499-5672

Email: services@perfusion.com

www.rand-biotech.com

