

Display Rules and Regulations

Linear Booth

Linear Booths, also called “in-line” booths, are generally arranged in a straight line and have neighboring exhibitors on their immediate right and left, leaving only one side exposed to the aisle. Display materials should be arranged in such a manner so as not to obstruct sight lines of neighboring exhibitors. The maximum height of **8 feet** is allowed only in the rear half of the booth space (green area), with a 4 foot height restriction imposed on all materials in the remaining space forward to the aisle (red area).

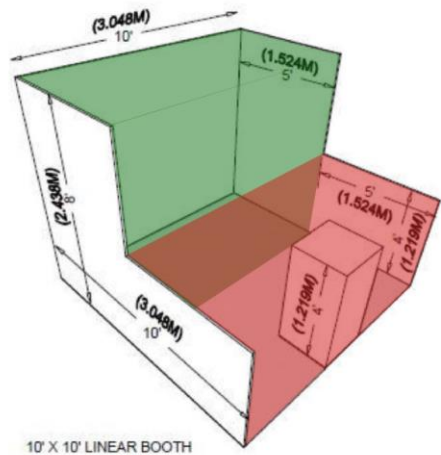
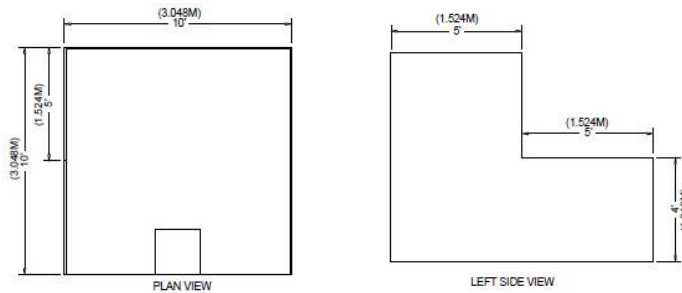

Island Booth

An island booth is any size booth exposed to aisles on all four sides. The entire cubic content of the space may be used up to the maximum allowable height (20 feet).

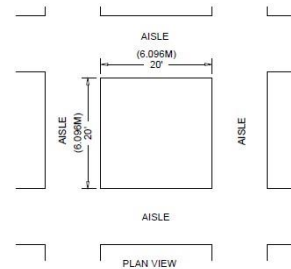
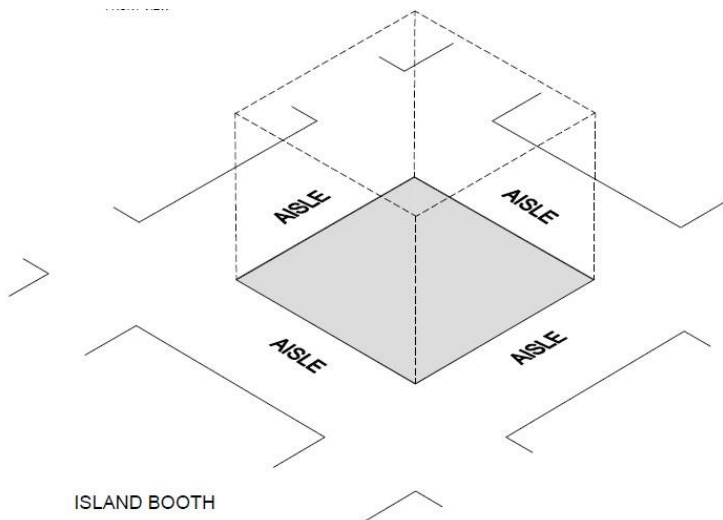

ADDITIONAL GUIDELINES

All exhibit materials must be **COMPLETELY** contained within the rented exhibit space

Products and signs may not be attached or affixed to the back or side pipe and drape